

Products Catalog



Next level
partnership



 **VERLINDE**
LIFTING EQUIPMENT

The story of a dedicated business



Founded in 1858, VERLINDE offered the French Navy and army engineering corps a revolutionary "endless screw hoist".

In 1918, with electrification in its early days, VERLINDE was the first French contractor to design and market electrically powered winches and hoists.

Set up in the central region of France, VERLINDE is France's leading maker and exporter of hoisting and handling equipment.

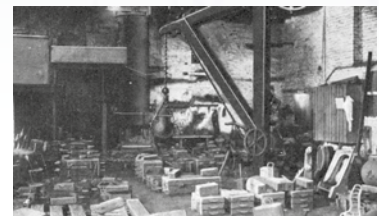
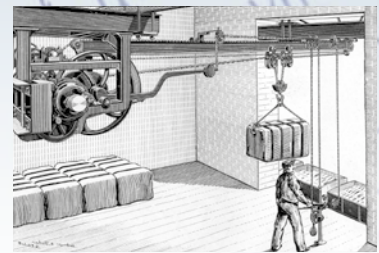



Each product bearing the VERLINDE brand is the outcome of production facilities that are constantly improved and adapted to cutting-edge design techniques.

The materials and components used for the manufacture of our products are subjected to the most stringent checks.

At its various production plants, VERLINDE mass produces wire rope, chain, belt electric winches, together with travelling crane components.



A high performance production facility



Lifting operations specialist 60 to 250,000 kg



Sales team well-acquainted with hoisting techniques analyse the problems set by each installation project (10 agencies in France and other agencies and commercial operations in over 55 countries throughout the world).

A rapid answer to your problems : our sales team can respond immediately to any request for standard equipment, whilst for more specialised queries, our Engineering Service will respond very rapidly.

Rush, one-off deliveries : the planning schedule is a key instrument in our activity - our plants are organised to meet out-of-the-ordinary requests.

The following commercial services are also at your disposal :



This Verlinde SA department is exclusively dedicated to our network of dealers :

- Specialist sales engineers
- A wide range of distribution products available from stock, off-the-shelf.
- Express delivery



This VERLINDE SA department offers you made-to-measure hoisting solutions :

- Hoisting units built to your specifications.
- A wide range of explosion-proof and spark-proof hoisting equipment.
- Special hoists : EDF type (Nuclear Power Plant), Renault, PSA,...



A network of crane builders - EUROPONT - of which Verlinde handles needs in Belgium and Holland.

www.europont.com



This department works exclusively on sales of handling systems meeting the needs of the theatre and scenic arts (show business) industry.

www.stagemaker.com

The Verlinde national After-Sales Service network

VERLINDE-approved specialists can install your equipment, draw up your maintenance contracts and refurbish your equipment.

> **VERLINDE After-Sales technicians** are fully familiar with your hoist systems and therefore can be relied upon for any work that is needed on your fleet of equipment.

> **The After Sales agencies** offer the following services :

- Supply and replacement of genuine constructor spare parts (all makes).
- Supply, installation and commissioning of hoisting systems.
- Supply and installation of roller paths and electrification systems.
- Express customer support.
- Regular inspections.
- Maintenance contracts (preventive, corrective or scheduled).
- Bringing into compliance.
- Upgrading.
- Training.
- Management of your fleet.



www.savverlinde.com

Verlinde spare parts centre

The VERLINDE After Sales Centre offers the services of a team of technical advisers, a stock of very rapidly available spares for all our products, genuine VERLINDE and UNELEC spares (for other brand on request) for your older hoist systems.



Verlinde training centre

Our training centre offers theoretical and practical courses on our products backed by recycling sessions on changing hoisting system technologies (automatic operations, on-board electronics, remote control, inverter drive,...).



Electric winches and hoists

| | |
|--|----|
| EUROCHAIN VX | 08 |
| Electric chain hoist for loads from 63 to 10,000 kg. | |
| STAGEMAKER | 14 |
| Industrial electric chain hoist especially adapted to "show-business" applications for loads from 125 to 5,000 kg. | |
| EUROBLOC VT | 18 |
| Electric wire rope hoists for loads from 800 to 80,000 kg. | |
| EUROBLOC VT9-10-11-12 | 22 |
| Electric wire rope hoists for loads from 10,000 à 250,000 kg. | |
| EUROLIFT BH | 24 |
| Electric belt hoists for loads from 500 to 5,000 kg. | |
| TIRLIFT 2 | 26 |
| Electric single and 3 phases winches for loads from 125 to 1,500 kg. | |
| TVI | 28 |
| Industrial 3 phases winch for loads from 1,000 to 10,000 kg. | |
| TEC | 29 |
| Electric 3 phases winche for loads from 600 to 10,000 kg. | |
| MR | 30 |
| Single phase electric winch for loads from 150 to 500 kg. | |

Manual winches and hoists

| | |
|--|----|
| VHR | 32 |
| Hand chain block for loads from 250 to 20,000 kg. | |
| ZHV | 34 |
| Manual chain hoist for loads from 500 to 50,000 kg. | |
| ZHV - HPR | 36 |
| Hand chain block with low headroom trolley construction for loads from 1000 to 30,000 kg | |
| PLV | 37 |
| Hand lever block for loads from 250 to 3,000 kg. | |
| Endless screw winch and geared winch type ME and type MV for loads from 250 to 3,000 kg. | 38 |
| MT | 38 |
| Manual winch for loads from 150 and 300 kg. | |

Trolleys and accessories

| | |
|--|----|
| CHD - CHDD | 40 |
| Manual travel trolley for loads from 250 to 20,000 kg. | |
| CHZ | 42 |
| Manual travel trolley for loads from 1,000 to 10,000 kg. | |
| CHZ INOX | 43 |
| Stainless steel trolley for loads from 500 to 1,000 kg. | |
| CHVX | 44 |
| Electric variable speed travel trolley for loads of 63 to 3,200 kg. | |
| PRD | 46 |
| Trolleys designed for hand operated articulated sliding girders system for loads from 250 to 2,000 kg. | |
| PRV | 46 |
| Trolleys for powered articulated sliding girder system for loads from 250 to 2,000 kg. | |
| PAP | 47 |
| Girder clamp for loads from 1,00 to 5,000 kg. | |
| LIMITER | 48 |
| Range of load limiters for wire rope and chain hoists. | |
| PEV | 49 |
| Electronic force gauges for loads from 200 to 32,000 kg. | |
| EQUIBLOC | 50 |
| Range of load balancers for loads from 0,7 kg to 55 kg. | |
| EQUIBLOC AIR | 51 |
| Range of air load balancers for loads from 70 to 350 kg. | |
| PAL | 52 |
| Range of lifting beams for loads from 1,000 to 10,000 kg. | |

Jib cranes, gantry cranes and travelling cranes

| | |
|--|----|
| EUROSYSTEM STD | 54 |
| Overhead handling system in steel profile for loads up to 2,000 kg. | |
| EUROSYSTEM ALD | 56 |
| Overhead handling system in steel profile for loads up to 2,000 kg. | |
| EUROSTYLE | 58 |
| Range of manual and motorized jib cranes. | |
| EUROSTYLE TEMPLIER | 60 |
| Range of manual articulated jib cranes. | |
| EUROSTYLE GAMME H₂O | 62 |
| Aluminium and galvanized jib cranes for water treatment systems. | |
| GANTRY CRANES VGI VGIM VGPS VGPA | 63 |
| Range of manual gantry cranes for loads from 250 to 6,000 kg. | |
| MANUAL CRANES | 66 |
| Range of hand operated top-running travelling cranes for loads from 250 to 10,000 kg and span of up 18 meters. | |
| EUROPONT | 67 |
| Program of EUROPONT VERLINDE's standard travelling cranes. | |
| COMPOSANTS+ | 68 |
| Range of crane components. | |

Electronic devices

| | |
|--|----|
| EUROMOTE | 70 |
| Range of radio controls for hoists and cranes. | |
| VARIATOR | 71 |
| Hoisting and travelling speed variation systems for hoists and overhead travelling cranes. | |
| VARIATOR ASR-ESR | 72 |
| Adapted Speed Range. Extended Speed Range. | |
| ESP | 73 |
| Automatic load swinging (pendulum) correction system. | |

Electric hoists and winches

Definition of Hoist : a device designed to lift and move heavy loads via a pulley system.



EUROCHAIN VX
STAGEMAKER
EUROBLOC VT
EUROLIFT BH
TIRLIFT2
TVI
TEC
MR



EUROCHAIN VX



Electric
chain hoist
for load from
63 to 10,000 kg

Here comes the new VERLINDE electric chain hoist for load from 63 to 10,000 kg.

After two years designing the next level of chain hoist technology and production, we are ready to present our new series in the light lifting version.

VERLINDE's Chain hoist historical family: **latest generation of Verlinde technology !**



1858

First hoist

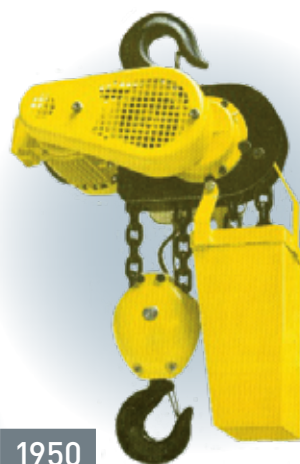

1950

PEC



1974

Eurochain 2



1989

Eurochain VE



1997

Eurochain VL



2011

Eurochain VR



EUROCHAIN VX

Electric chain hoist for load
from **63 to 10,000 kg**

1

Modernized outlook

> Novelty, hoist dimensions reduced,
better hook approach.

2

Optimized chain collector boxes

> Robustness, safety.

5

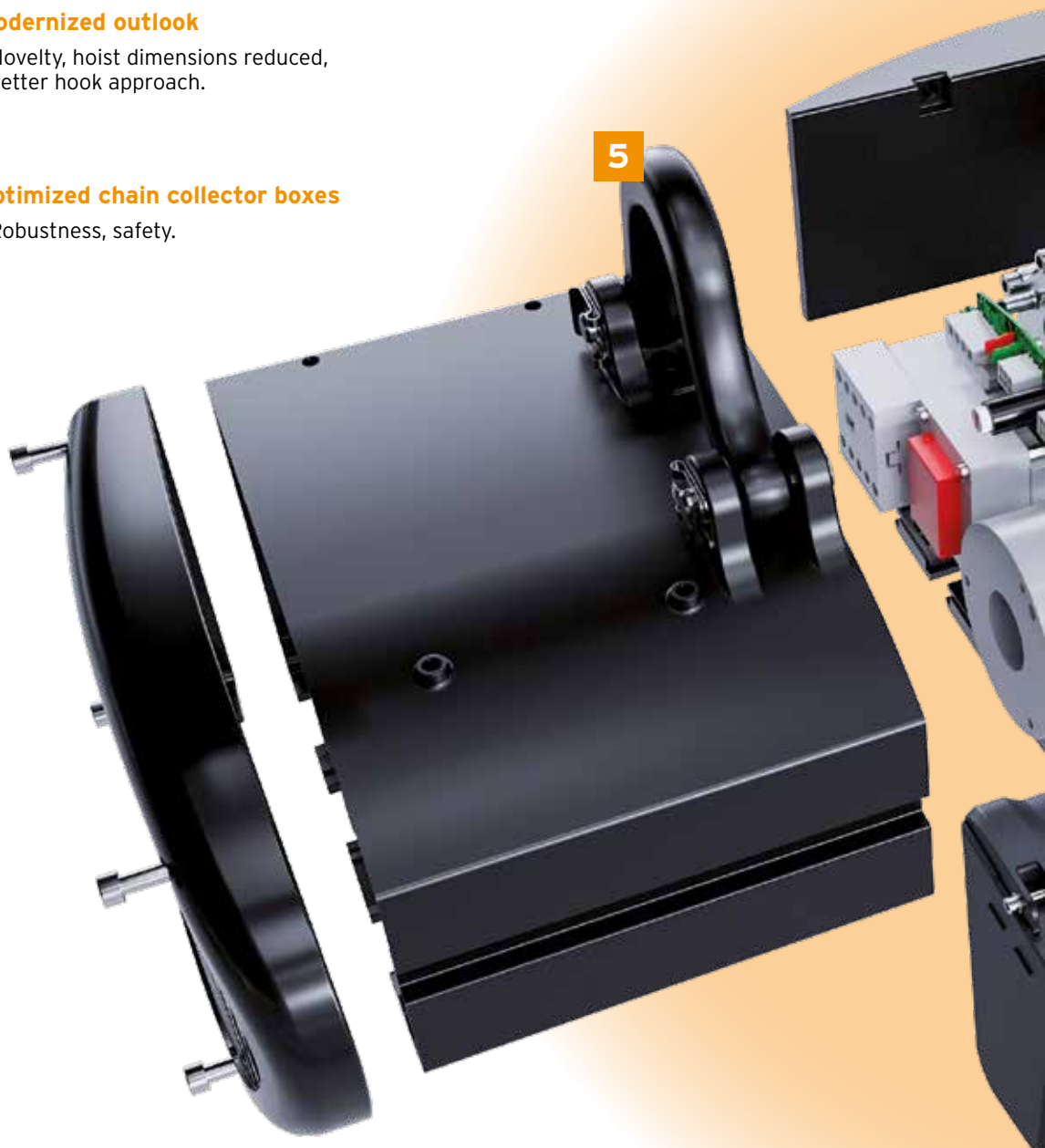

3

Long-life brake disc

> Improved reliability and safety,
no adjustments required, low maintenance.
> Proven technology.





4

Long-life limit switch

- › Safety, hook positioning, monitoring, proven technology.

5

New bracket suspension

- › Easy installation, compatibility with existing trolleys.
- › Improved hook path due to reduced C-dimension.

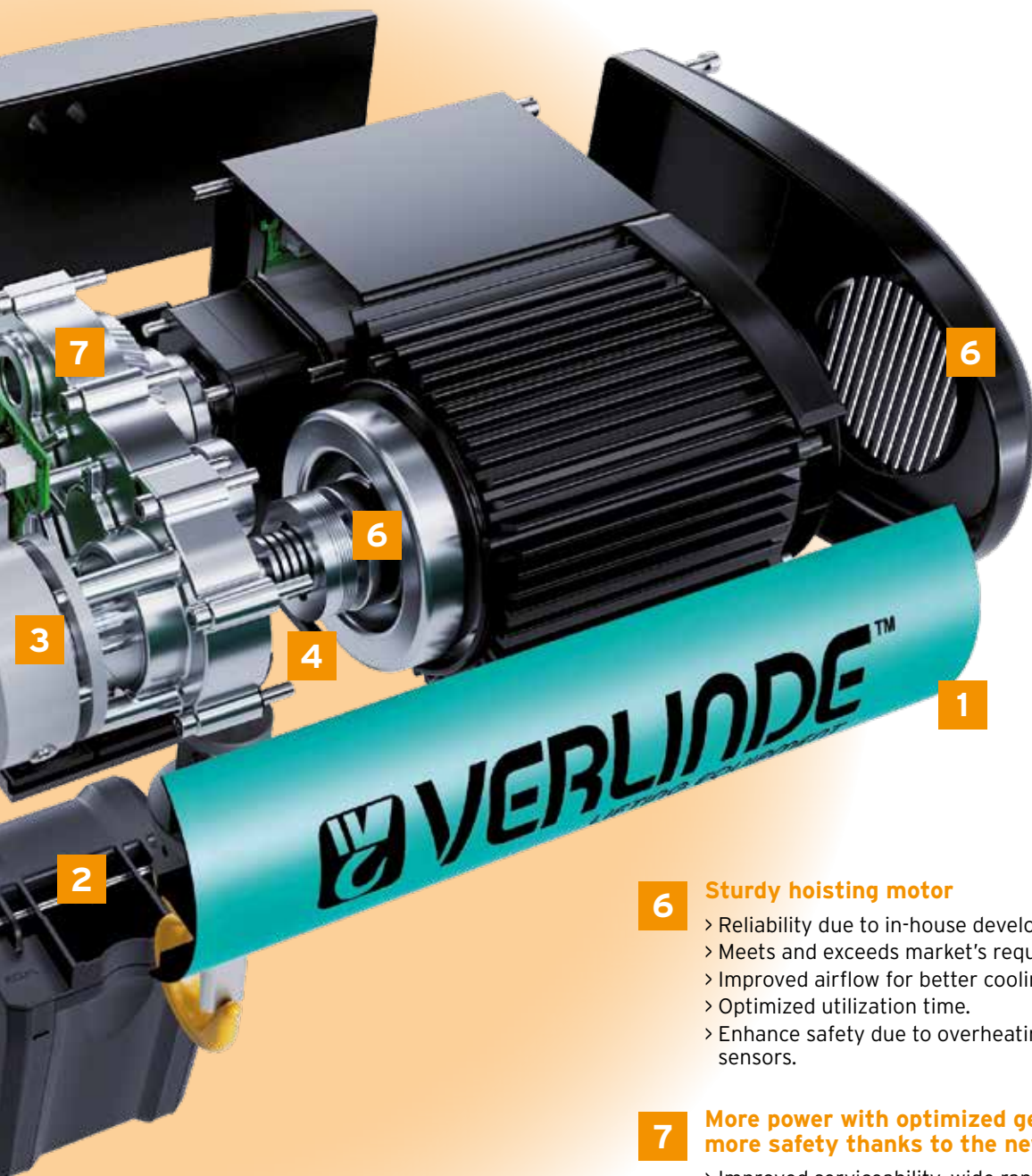

6

Sturdy hoisting motor

- › Reliability due to in-house development.
- › Meets and exceeds market's requirement.
- › Improved airflow for better cooling of the motor.
- › Optimized utilization time.
- › Enhance safety due to overheating preventive sensors.

7

More power with optimized gear parts and more safety thanks to the new clutch design

- › Improved serviceability, wide range of ratios to fit better customer applications to maximize productivity, more precise and durable clutch setting, easiness of clutch adjustment, protects people, hoist, crane and building structure from overloads.
- › Proven technology.



EUROCHAIN VX

Electric chain hoist for load
from **63 to 10,000 kg**

EUROCHAIN VX hoist range

| Load (kg) | Hoist type | Group (ISO) | Lifting speed (m/min) | Reeving | Chain size |
|-----------|-------------|-------------|-----------------------|---------|------------|
| 63 | VX2 0608b3 | M6 | 8/2 | 1 | 4,1 x 12,1 |
| | VX2 0612b3 | M6 | 12/3 | 1 | 4,1 x 12,1 |
| | VX2 0616b3 | M6 | 16/4 | 1 | 4,1 x 12,1 |
| | VX2 0624b3 | M6 | 24/6 | 1 | 4,1 x 12,1 |
| 125 | VX2 1208b3 | M6 | 8/2 | 1 | 4,1 x 12,1 |
| | VX2 1212b3 | M6 | 12/3 | 1 | 4,1 x 12,1 |
| | VX2 1216b2 | M5 | 16/4 | 1 | 4,1 x 12,1 |
| 160 | VX2 1608b3 | M6 | 8/2 | 1 | 4,1 x 12,1 |
| | VX2 1612b3 | M6 | 12/3 | 1 | 4,1 x 12,1 |
| | VX5 1616b1 | M4 | 16/4 | 1 | 5,1 x 15,1 |
| 250 | VX2 2508b2 | M5 | 8/2 | 1 | 4,1 x 12,1 |
| | VX5 2512b1 | M4 | 12/3 | 1 | 5,1 x 15,1 |
| | VX5 2504b3 | M6 | 4/1 | 1 | 5,1 x 15,1 |
| | VX5 2508b3 | M6 | 8/2 | 1 | 5,1 x 15,1 |
| | VX5 2516b2 | M5 | 16/4 | 1 | 5,1 x 15,1 |
| 320 | VX5 3208b2 | M5 | 8/2 | 1 | 5,1 x 15,1 |
| 500 | VX2 504b2 | M5 | 4 / 1 | 2 | 4,1 x 12,1 |
| | VX5 504b2 | M5 | 4 / 1 | 1 | 5,1 x 15,1 |
| | VX5 508b2 | M5 | 8 / 2 | 1 | 5,1 x 15,1 |
| | VX10 512b2 | M5 | 12 / 3 | 1 | 7,2 x 21,1 |
| | VX10 504b2 | M5 | 4 / 1 | 1 | 7,2 x 21,1 |
| | VX10 508b3 | M6 | 8 / 2 | 1 | 7,2 x 21,1 |
| | VX10 516b2 | M5 | 16 / 4 | 1 | 7,2 x 21,1 |
| 630 | VX5 6304b2 | M5 | 4/1 | 2 | 5,1 x 15,1 |
| | VX10 6316b1 | M4 | 16/4 | 1 | 7,2 x 21,1 |
| 1000 | VX5 1004b2 | M5 | 4/1 | 2 | 5,1 x 15,1 |
| | VX10 1004b2 | M5 | 4/1 | 1 | 7,2 x 21,1 |
| | VX10 1006b2 | M5 | 6/1,5 | 1 | 7,2 x 21,1 |
| | VX10 1008b2 | M5 | 8/2 | 1 | 7,2 x 21,1 |
| 1250 | VX10 1204b1 | M4 | 4/1 | 1 | 7,2 x 21,1 |
| | VX10 1208b1 | M4 | 8/2 | 1 | 7,2 x 21,1 |
| | VX10 1204b2 | M5 | 4/1 | 2 | 7,2 x 21,1 |
| | VX10 1204b2 | M5 | 6/1,5 | 2 | 7,2 x 21,1 |
| 1600 | VX10 1604b2 | M5 | 4/1 | 2 | 7,2 x 21,1 |
| | VX10 1606b2 | M5 | 6/1,5 | 2 | 7,2 x 21,1 |
| 2000 | VX10 2004b2 | M5 | 4/1 | 2 | 7,2 x 21,1 |
| | VX10 2006b1 | M4 | 6/1,5 | 2 | 7,2 x 21,1 |
| 2500 | VX10 2504b1 | M4 | 4/1 | 2 | 7,2 x 21,1 |

From 2,500 to 10,000 kg consult us



> Hoist dimensions

| Hoist type | Dimensions (mm) | | | Weight w/o chain (kg) |
|-----------------------|-----------------|-------|-----|-----------------------|
| | A | B | C | |
| EUROCHAIN VX2 | 387 | 297.6 | 141 | 22.5 (24.1*) |
| EUROCHAIN VX5 | 410 | 345.9 | 157 | 30 (35.3*) |
| EUROCHAIN VX10 | 483 | 417 | 196 | 53 |

*Hoist with counterweight

> Standard equipments

The electric chain hoist EUROCHAIN VX includes the following equipment as standard:

- > Height of lift 3 m.
- > Bracket suspension for suspended hoist.
- > 2 hoisting speeds.
- > Safety limit switch for upper & lower position.
- > IP55 hoisting & travelling motor protection.
- > Load chain galvanized.
- > Control cable 2,5 m.
- > 2 buttons pendant for hook suspended hoist or manual trolley.
- > 4 buttons pendant for hoist with electric trolley.
- > Power supply 400V/3Ph/50Hz or 415V/3Ph 50 Hz or 460V/3Ph /60 Hz.
- > Low voltage control 48 V.
- > Torque limiter.
- > Chain collector.
- > Emergency stop button mushroom type.
- > Paint 5 years guaranteed (RAL 7021).
- > Variable travelling speed (for hoist with electric trolley)
- > 2 years guaranteed.

> Available versions

- > Fixed hoist suspended by bracket.
- > Hoist on monorail push trolley.
- > Hoist on monorail motorized trolley.

> Options available

- > Non standard power supply (ex. : 230 3ph).
- > ACF board for direct control hoist.
- > Hard wired control (48V).
- > Stainless steel lifting chain and hook.
- > Self locking hook.
- > Time meter.
- > Radio remote control.
- > Pendant with 4 or 6 buttons.
- > Key switch on pendant.
- > Travel limit switches.
- > Non standard length on power supply cable.
- > Non standard power supply plug (4 or 5 poles).
- > Rain cover.
- > Brake manual release.
- > Food contact oil (NSF H1).
- > Gear limit switches 2 or 4 steps.
- > Digichain.



STAGEMAKER

SL

new



Industrial chain type electric hoist specially adapted to "show-business" applications for loads from 125 to 5,000 kg

IP66
available soon

D8+
as standard
SPQ2

+ savings

Maintenance operations are now simpler, faster and more economical :

- > Easy access to the torque limiter.
- > Easy access to safety fuses.
- > New concept of easily dismountable hoisting motor.
- > Easy access and removal of plug and play electronic boards.
- > Easy visual access to the brake for control.

> Optional equipment

- > Single brake.
- > Pushbutton controller.
- > 4, 8, 12,... channels controllers.
- > Low voltage control (48 V) version B.
- > Large range of flight cases.
- > Non rotating hook.
- > Suspension bracket instead of upper hook.
- > Industrial chain guide.
- > Encoder.
- > Load measuring system.
- > Rain cover protection.



+ safety

- > Stagemaker SL & SR is **D8+ as standard** (SPQ2) and D8 by removing one brake.
- > **Double lifting brake as standard** for more safety.
- > **IP66 protection** as standard for the entire hoist (being validated).
- > Clutch concept. The clutch position in the reducer ensures the load is held by the brake regardless of the machine's daily operating conditions.
- > Magnetic limit switch as standard on all SL5 and SL10 (version B) with standard Limitflux.
- > **G100 Black electro galvanized lifting chain as standard** manufactured specifically for Stagemaker.
- > All hoist motor as integral thermal protection to prevent overheating (version B).



+ operating convenience

- > Operating sound level down to 60 db (test certificate available).
- > Climbing hoist or industrial suspension configuration can be changed simply by reversing the chain container.
- > Rotating upper and lower hooks.
- > High capacity and high strength chain bag made of 1100 denier, high grade black fabric, is both removable and reversible.
- > Rubber buffers located on the hoist corners provide added protection for the hoist.
- > Motor design provides consistent speeds when both fully loaded or unloaded.
- > Electrical components designed for "plug and play" connectivity.

+ innovation

PERFECT PUSH™

- > New "Perfect Push MKII", patented concept, 5 pocket load wheel.
- This innovation provides improved chain guiding and chain flow, to help reduce the risk of chain jamming.



CHAINFLUX™

- > Design provides a horizontal flow of the chain as it comes off of the load wheel.
- This design, along with the high strength aluminum construction, allows for a more fluid flow of the chain into the chain bag and helps reduce the risk of chain jamming. Drain in housing to avoid water collection in load wheel compartment.



+ improved ergonomics

- > Due to oval shape the chain can't be stuck on top of the motor, this reduces the risk of chain jamming. The design with its flowing and refined lines draws attention to its robustness and on-board technology and gives a strong impression of integral safety. The new streamlining provides STAGEMAKER SR and SL better integration in its operating environment (lighting, loudspeakers, etc.).
- > Hoist meets ecology regulations and is RoHS compliant.
- > The hoist body is powder coated with black (RAL 7021), protective 70 µm epoxy paint, allowing it to perform under the most extreme conditions (-10 C° to +40 C° / -4 to 122 degrees F).
- > Lifting hook has an ergonomic, rubber clad, gripping surface.
- > New ergonomic concept for the retractable, rubber clad handgrips, allow an easy transportation of the hoist (SL5 and SL10 as standard, SR1 as option).
- > Black CE P17 plug for better integration.



- > The Limitflux is a built-in limit switch device in the CHAINFlux MKII® that's allow to control setting of hoist or hook position in industrial suspension or climbing configuration.
- > Accuracy of the system is given at one link of lifting chain.
- > The setting of the limit is operated by two magnetic ring (upper and lower) which can be easily moved and set along the lifting chain.

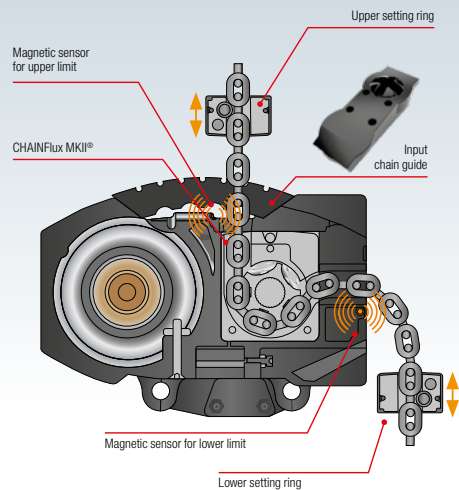
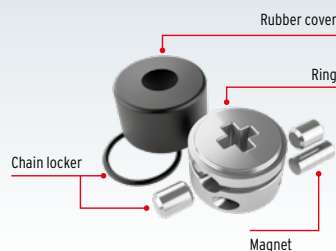

Radio load cell

> Advantages



- > Completely wireless: No messy cables & higher reliability: Multiple channels ensure reliable transmission. Each load cell transmits independently no danger of damage to one cable that will ruin the entire system ability to monitor the loads. STAGEMAKER RADIO LOAD CELL's very long battery life enables complete independence of the power system. This, together with UPS (Uninterruptable Power Supply) to backup the central radio receiver, enables continuous load monitoring even in power shut down. Especially suitable for touring and rentals.
- > With SRLI : one-time installation and then the load cell can stay as integral part of the hoist during entire tours, saving the installation time.
- > Very low headroom loss.
- > Up to 200 load cells on one Central Radio Receiver.
- > Load cells are available with a safety factor of 5 or 10.
- > No need for any extra accessories like shackles with SRLI.
- > Enables easy retrofit to all existing hoists that are in the market (entertainment and industrial).
- > Will make the periodical maintenance / service of the hoist easier.
- > Enables 5000 hours battery life, optional 10,000 hours i.e. more than a year of continuous use, no sleep mode or standby mode which are not acceptable from a safety point of view.

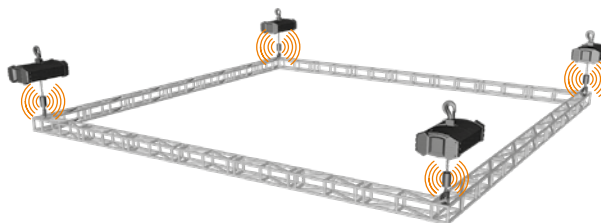

> Options

- > Additional channel.
- > Suitcase for storage and transportation of 4 or 8 load cell.
- > Set point : integration interface between load cell radio receiver and controllers sytem.
- > Real time cellular SMS alert on overload occurrence.
- > Common cable for load cell radio receiver.
- > Group screen display.
- > Slave & master Central Radio Receiver for increased range, harsh conditions, and the ability to monitor several halls in one control room.

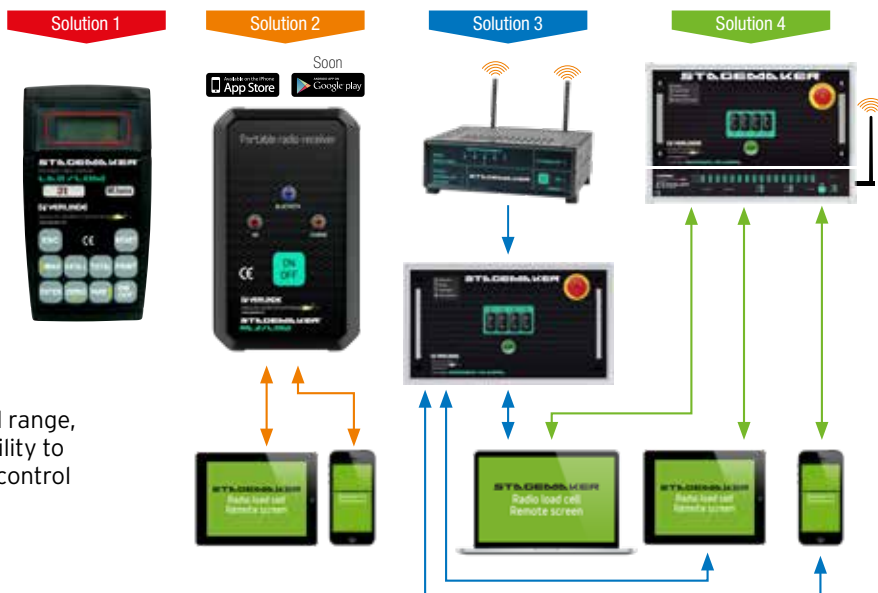

Controllers

3 Ranges are available from our catalog ECO, RIGGER, THEATER.

The controllers come with 4, 8 or 12 channels and can be integrated in a compact flight case (19" rack 3U to 6U) or a vertical flight case depending on the model. The STAGEMAKER Controller allows you to control the show motors individually or by group by simply pressing a button. Motor pre-selection system for each control unit, selection panel / remote control comes as standard feature.

The STAGEMAKER motors equipped with options such as : low voltage control, adjustable limit switch and thermal protection for lifting motor can also be controlled by this system using a single power supply cable. For larger applications, STAGEMAKER controllers can be connected together with master/slave functionality. All the motors selected will be activated simultaneously by a single button.

Other configurations are available on request.

The STAGEMAKER Controller satisfies the current European safety standards relative to electrical equipment (IEC & EMC) and has been approved by official European institutes. These control systems provide the user with a high level of flexibility, durability and safety.

▼ Altimeter



▼ Controller Rigger Rack 19"



▼ Controller Theater with radio emitter for remote control in option



Controller ECO >



Controller Rigger Suitcase >



Flight cases

A broad range of flight cases specially designed for the STAGEMAKER motors and controllers is available.



▲ Premium



▲ Eco



EUROBLOC VT

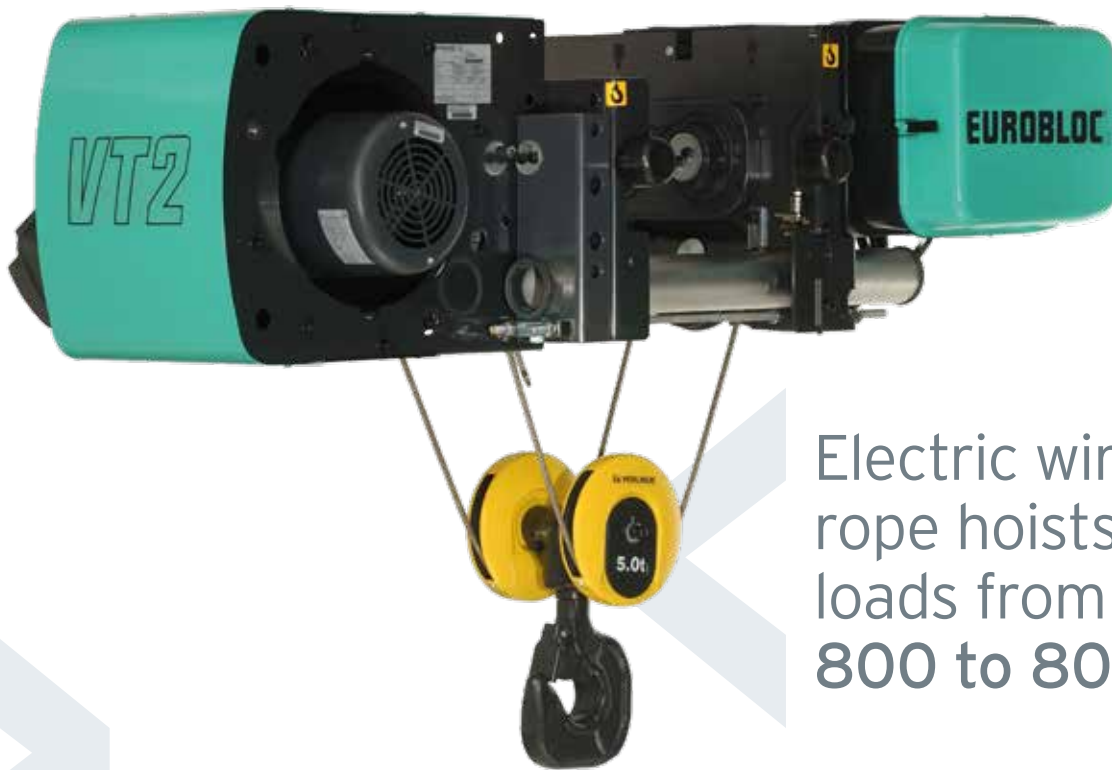

Electric wire
rope hoists for
loads from
800 to 80,000 kg

VERLINDE has always been in the vanguard for innovative ideas and designs for lifting units with hooks (over 70 patents filed in France and world-wide).

The new EUROBLOC VT electric wire rope hoist has been designed in this resolutely “avant garde” spirit - 13 patents have been approved from this design alone.



Also available in EUROBLOC VM
ESSENTIAL version for loads to
20,000 kg



Technical characteristics Eurobloc VT

- > 2-speed hoisting motor (ratio 1-6) with bimetal sensors. 60 % operating factor.
- > Maintenance-free DC disc brake.
- > 4-position limit switch (up, down, high position deceleration, reversed phase protection).
- > Load limiter.
- > Monitor MT2 or MT3, supervisor unit for the hoist (deliver as standard according type).
- > 3 to 20 m/min variable speed travelling motor.
- > Electrical cabinet with low voltage transformer and switchgear. Safety on/off.
- > Standard 380V/400V/415V/50Hz, 440V/460V/60Hz power supply.
- > IP55 / Class F protection system for motors.
- > Tropicalised for travelling and lifting.
- > Cable guide for difficult environments.
- > Time counter.



MT2 and MT3, supervisor unit.

Options available EUROBLOC VT

- > Higher travelling speeds.
- > Radio remote control.
- > Load limiter with 2 or 3 steps.
- > Special supply voltage.
- > Load display.
- > Explosion proof hoist. 



Available on the iPhone  Available on Google play 

eXPERTCARE

- > ExpertCare is a VERLINDE smartphone application enabling the remote display of information from floor level of the MT2 electronic monitoring module of EUROBLOC VT wire rope hoists mounted on overhead cranes.

Advantages of the EUROBLOC VT

- > Virtual vertical lift.
- > Compact dimensions.
- > Dimension "C" is compact to optimise hoisting height as much as possible.
- > Greater accuracy in moving loads, thanks to the variable travel speed (preventing the load from swinging).
- > Minimum approach distances.



Short "C" dimension.

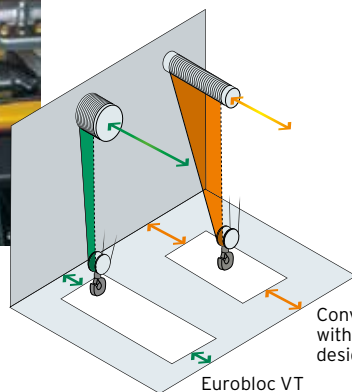

Conventional hoist with traditional design

Load capacity EUROBLOC VT

| | 2 000 kg | 3 200 kg | 10 000 kg | 20 000 kg | 40 000 kg | 80 000 kg |
|------------|----------|----------|-----------|-----------|-----------|-----------|
| > Type VT1 | | | | | | |
| > Type VT2 | | | | | | |
| > Type VT3 | | | | | | |
| > Type VT4 | | | | | | |
| > Type VT5 | | | | | | |
| > Type VM1 | | | | | | |
| > Type VM2 | | | | | | |
| > Type VM3 | | | | | | |

➤ Made-to-measure configurations

➤ Foot mounted or overhead mounted.



➤ Monorail trolley with standard headroom (HPN).



➤ Double girder trolley (fixed or suspended).



- Double girder trolley - Eurobloc VM Essential.



- Monorail trolley with short headroom (HPR) - Eurobloc VM Essential.



- Monorail trolley with short headroom (HPR).



- Monorail trolley with short headroom (HPR) and lifting inverter.



EUROBLOC VT9-10-11-12

Electric
wire rope
hoists
for loads from
10,000 to
250,000 kg



The EUROBLOC VT family has now been widened to include the VT9-10-11-12. This line of open winches offers technical solutions to meet your requirements for :

- > A greater hoist capacity (10 to 250 tons).
- > Lifting height (up to 103,6 m).
- > Utilisation group (ISO classification up to M6).
- > Hoist speed.
- > Speed control (speed variation).

> Technical characteristics

- > High performance hoist motor.
- > Very high safety level of hoist brake.
- > Smart supervision of brake by the variator with slip or jamming detection feature.
- > Double safety system for end of travel lifting (limit switches with detection of top and bottom position together with a limit switch tripped by the rope lead-off).
- > Travel limit switch as standard.
- > Overload protection.
- > Winch supervision with Monitor system.
- > IP55 and IP66 components.
- > Hoist motor insulation class F/H, IP55 protection, thermal protection.
- > Epoxy paint (thickness 120 µm).

> Advantages

- > Rapid and variable hoisting speed (with closed loop variator).
- > Virtual vertical lift.
- > Large load capacities avoiding use of twinned hoists.
- > A standardised maintenance platform available as option.
- > Optimal positioning of rollers on trolley enable best distribution of load on bearing structures.
- > An innovative rope guide system reduces stress on the wire rope and lengthens life span.
- > The large diameter drum provides :
 - increased life span of hoist rope.
 - reduction in rail widths and approach distances to optimise the working area of the winch.



> Options available

- > Service platform.
- > Double brakes.
- > Wire rope press roller.



EUROLIFT BH

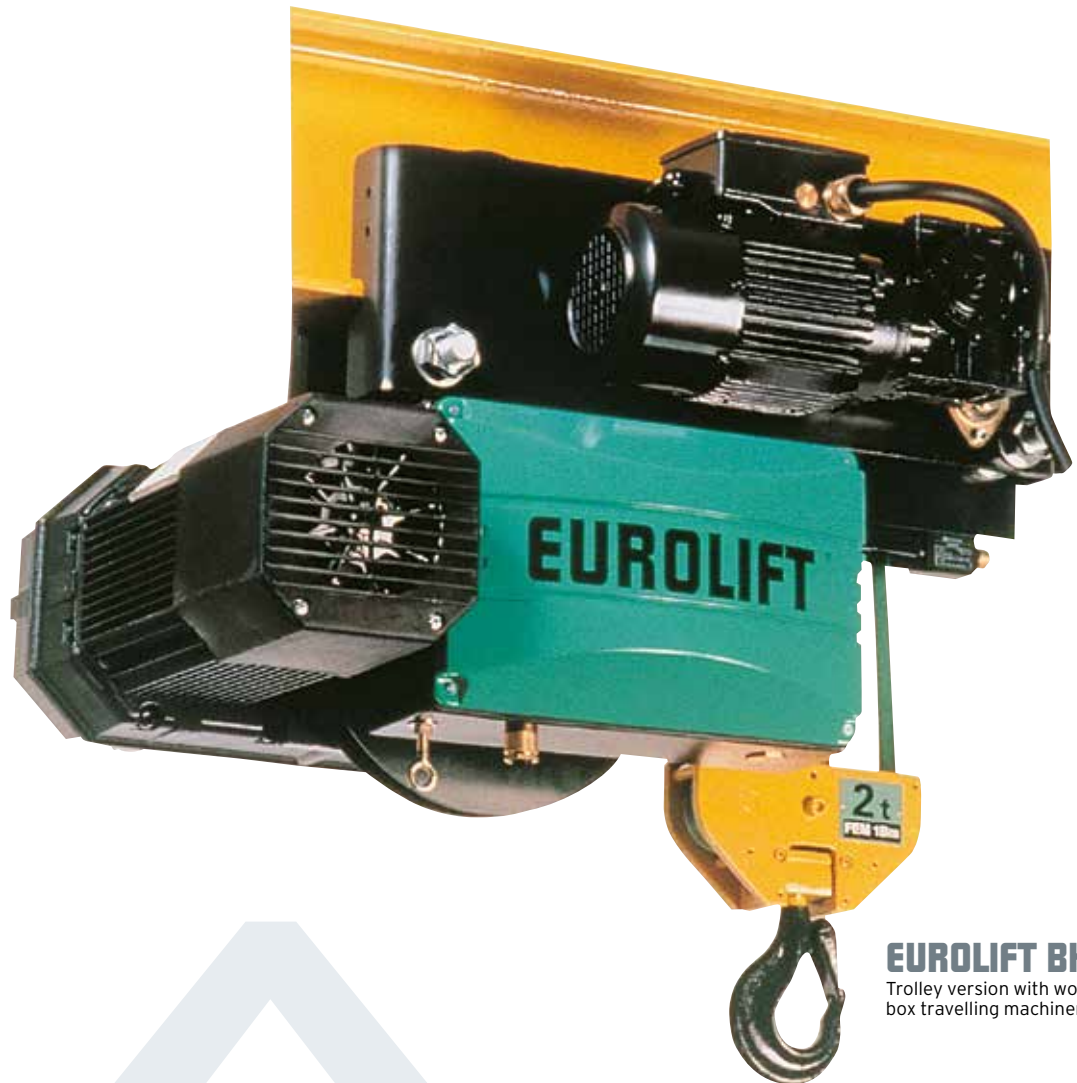

EUROLIFT BH
Trolley version with worm gear
box travelling machinery

Electric belt hoists for loads from
500 to 5,000 kg



The EUROLIFT BH electric belt hoist meets your needs for hoisting power with the strictest levels of cleanliness. The EUROLIFT BH is a hoist complying with EC European standards, offering you the lifting power and robustness of a product designed for industrial duty combined with 100% clean operation to meet your most stringent requirements with regard to hygiene, handling of foodstuffs and chemical products and “white room” conditions,...



Technical characteristics

- > Anticorrosion product with high strength rot-proof belt.
- > Exceptionally little loss of headroom, enabling the EUROLIFT BH to adapt to all your installation configurations.
- > Lift motor with two mechanically variable speeds and two speed travel movement motor (complying with standard EC 34.1/IEC 34.2, IP 55 protection and insulation F) combined with perfectly sealed reduction gearing enabling your loads to be shifted silently with great precision.
- > A high security belt guide, electric hoisting limit switch and electrical load limiter as standard equipment, ensuring you, as user, maximum safety in every situation.
- > Variable speed travel motor for precise positioning of loads.
- > An option of this lifting unit offers greater protection with stainless steel or galvanised elements and an EX spark proof and/or explosion proof version (ATEX standard) is also available.

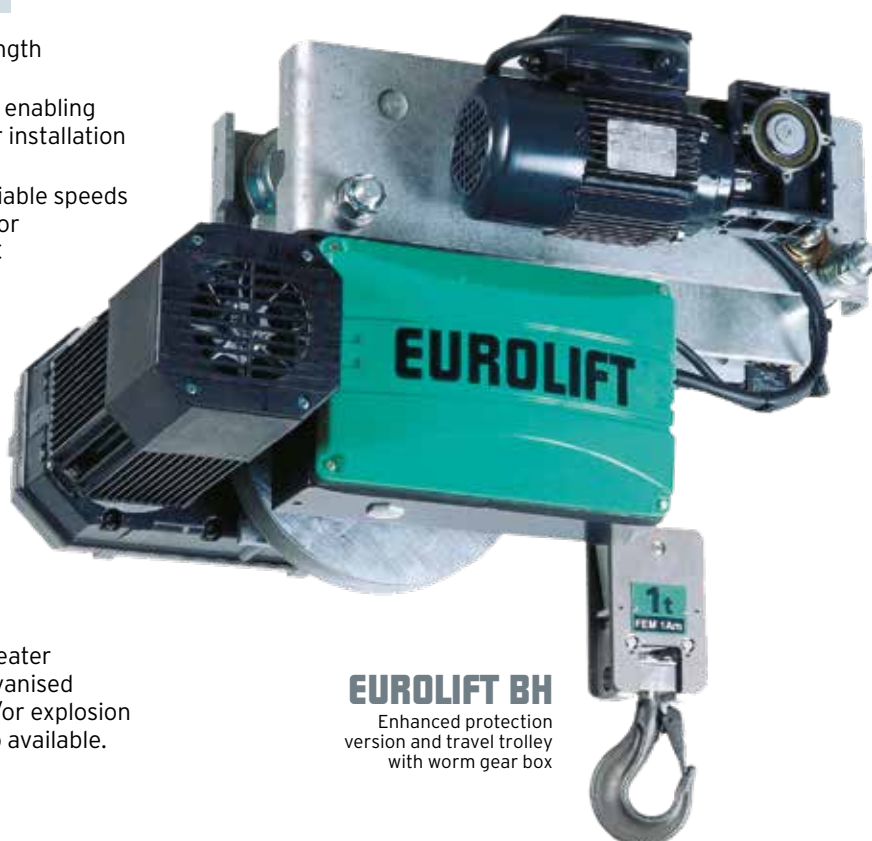

EUROLIFT BH
Enhanced protection
version and travel trolley
with worm gear box





TIRLIFT 2

Electric **single and 3 phases** winches for loads from **125 to 1,500 kg**

This line of all-purpose electric winches for lifting and traction adapt perfectly to all your needs (wide load range, speed, numerous options). They are designed for the lifting of loads of 125 kg to 1,500 kg. Compliance with the EC directive concerning machines.

> Technical characteristics

These winches comply with directive CE 2006/42/CE are designed for pulling and lifting of loads between 125 kg and 1,500 kg (Class FEM 1Am, 2m).

TIRLIFT type TL and TC electric winches offer the following standard features :

- > Protection of electrical components (control panel and motor), type IP55.
- > Totally enclosed, life lubricated, helicoidal gear treated (type according load range).
- > One or two lifting speed or variable speed.
- > A start/stop contactor (for type B and C equipment).
- > A 48 V Low Voltage transformer (for type B and C equipment).
- > A wide line of hoisting motor with insulation class F, IP 55 protection.
- > Spring loaded disc brake.
- > A modular and evolutional under-frame allowing many directions for wire rope outlets from the drum.

> Options available

- > Tropicalized motor.
- > Thermal protection.
- > Others voltage (delay from 3 to 6 weeks).
- > Additional length of cable for the buttons box or the remote cubicle per meter.
- > Lifting limit switch.
- > 4 step gear limit switch (IP66).
- > Drum rope pressure roller.
- > Manual brake release.
- > Left or right grooved drum (1 anchor).
- > Left or right grooved drum (2 anchors).
- > Left and right grooved drum (2 anchors).
- > Left or right grooved drum (1 anchor) for tube higher diameter.
- > Left or right grooved drum (2 anchors) for tube higher diameter.
- > Left and right grooved drum (2 anchors) for tube higher diameter.
- > Add anchor rope.
- > Center separation plate.
- > Motor cover (available only with A and C type).
- > Load limiter (1 speed).
- > Radio control = emitter + receiver (Hauling).
- > Add emitter (Hauling).
- > Radio control = emitter + receiver (Lifting).
- > Add emitter (Lifting).
- > Tubular protection Frame.
- > Counter weight 10 kg for cable Ø 4/5/6.
- > Counter weight 20 kg for cable Ø 7/8.
- > Counter weight 25 kg for cable Ø 9/10.
- > Counter weight 50 kg for cable Ø 11,5/13.

Examples of use

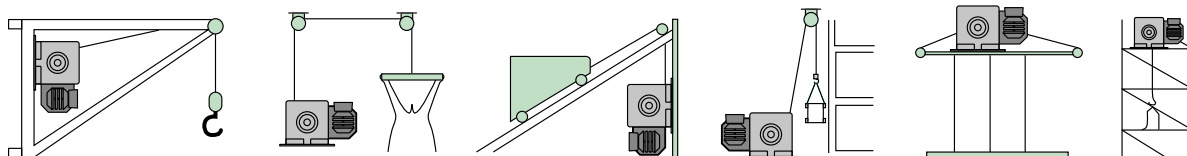

Rope exists

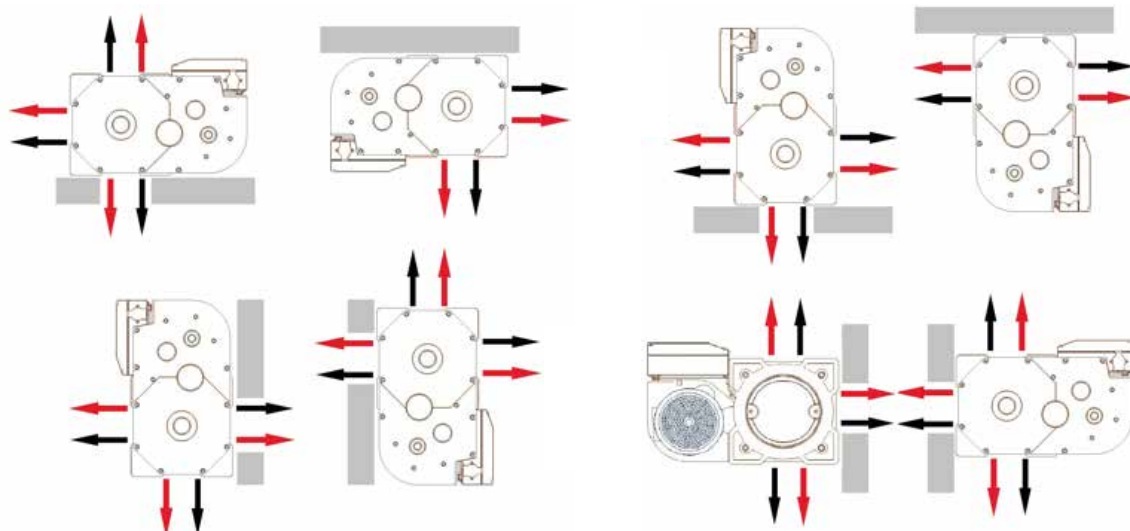

Load capacity TIRLIFT2

| | 125 kg | 250 kg | 500 kg | 750 kg | 1000 kg | 1250 kg | 1500 kg |
|-------------|--------|--------|--------|--------|---------|---------|---------|
| > Type TC1 | | | | | | | |
| > Type TL1 | | | | | | | |
| > Type TC2 | | | | | | | |
| > Type TL2 | | | | | | | |
| > Type TC5 | | | | | | | |
| > Type TL5 | | | | | | | |
| > Type TC8 | | | | | | | |
| > Type TL8 | | | | | | | |
| > Type TC9 | | | | | | | |
| > Type TL9 | | | | | | | |
| > Type TL15 | | | | | | | |
| > Type TL15 | | | | | | | |

TVI



Industrial electric
3 phases winch
for loads from
1,000 to 10,000 kg

The range of compact electric winches TVI designed for the industrial market.

Due to the robustness, the compact dimensions, the wide range of load capacity, the large availability of options, the diversity of possible attachment, the TVI is perfectly adapted to all standard lifting or pulling/hauling applications.

Technical characteristics

- > Power supply 230 / 400 V / 3 Ph / 50Hz.
- > Electric cubicle IP 55 on the winch.
- > Low voltage control 24V - Thermal circuit breaker.
- > Drum length : 350 mm.
- > Planetary gear box.
- > Push button box with emergency stop.
- > 3 meter control cable.
- > Several rope exit and options available.

Options available :

- > IP66 limit switches.
- > Additional rope fixation.
- > Load limiter.
- > Grooved drum 1 fixation.
- > Grooved drum 2 fixations.

- > Brake release.
- > Add shaft.
- > Drum length modification.
- > Drum cover at 3/4 surface.
- > Total drum cover protection.
- > Special motor voltage.
- > Motor tropicalized.
- > IP 56 motor.
- > IP 65 motor.
- > H class motor.
- > Slack rope detection.
- > Pressure roller.
- > Variable speed.
- > Offshore paint.
- > Radio remote.

Load capacity

| | 1000 kg | 2000 kg | 3000 kg | 4000 kg | 5000 kg | 6000 kg | 7000 kg | 8000 kg | 9000 kg | 10 000 kg |
|---------------|---------|---------|---------|---------|---------|---------|---------|---------|---------|-----------|
| > Type TVI 1 | ■ | | | | | | | | | |
| > Type TVI 2 | ■ | ■ | | | | | | | | |
| > Type TVI 3 | ■ | ■ | ■ | | | | | | | |
| > Type TVI 4 | ■ | ■ | ■ | ■ | | | | | | |
| > Type TVI 5 | ■ | ■ | ■ | ■ | ■ | | | | | |
| > Type TVI 6 | ■ | ■ | ■ | ■ | ■ | ■ | | | | |
| > Type TVI 7 | ■ | ■ | ■ | ■ | ■ | ■ | ■ | | | |
| > Type TVI 8 | ■ | ■ | ■ | ■ | ■ | ■ | ■ | ■ | | |
| > Type TVI 9 | ■ | ■ | ■ | ■ | ■ | ■ | ■ | ■ | ■ | |
| > Type TVI 10 | ■ | ■ | ■ | ■ | ■ | ■ | ■ | ■ | ■ | ■ |



> Anti-escape system for the rope. Reduced space between the tie-rod and the drum.



> Frame part are mobile according rope exit.



> Rope pressure roller and slack rope detection integrated to upper main frame.

TEC

Electric 3 phases winch for loads from 600 to 10,000 kg



This range of all-purpose electric winches for hoisting and pulling provides the perfect solution to all your needs with its wide range of loads and the considerable number of options available. What is more, the rugged design of this winch is a warrant for an extremely long service life requiring very little maintenance.

Technical characteristics

- > A 230/400 V - 50 Hz 3-phase electric motor.
- > A low voltage electromagnetic brake with automatic take-up of wear.
- > Type IP 54 protection for the switchgear (cabinet and motor).
- > An emergency stop pushbutton box on a 3 meters long spiral cable.
- > An ON/OFF contactor.
- > A 24 V low voltage transformer.
- > A thermal cutout circuit-breaker.
- > A primary down gearing by an oil bath reduction box.
- > A secondary down gearing by gear under a cover (except for the TEC® 7).
- > A modular design frame amenable for changes (for instance a multiple choice of exits to lead out the cable from the drum).
- > Comply with directive CE 2006/42/CE.

Rope exits

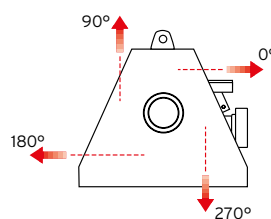
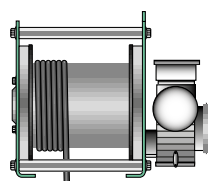

> Right exit (rope) - Standard configuration

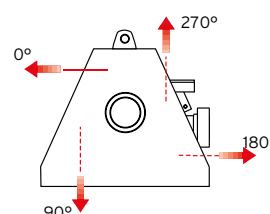
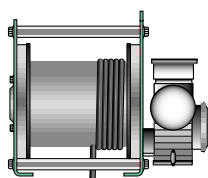

> Left exit (rope) - Option

Options available

- > Tubular protective cradle for use on construction sites.
- > Upper travel and lower travel limit switches.
- > Manual release of brake via actuating handwheel.
- > Mechanical de-clutching of drum (except TEC® 7).
- > 2-speed motor or variable speed.
- > Detection slack in cable.
- > Radio control as alternative to pushbutton box.
- > Grooved cable drum.
- > Special length drum.
- > Several cable exits from drum.
- > Cable press roller.
- > Cable connection on motor.

Examples of uses

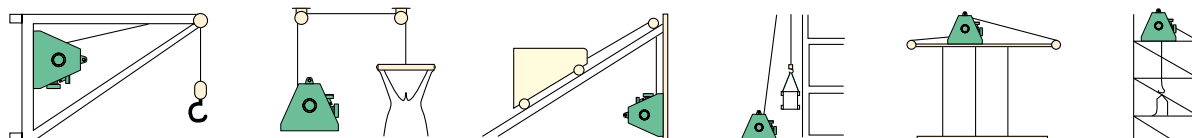

MR



Single phase electric winch for loads from 150 to 500 kg

Single-phase electric winch designed for lifting and traction simple, ideal to replace a manual winch, used in cases of occasional maintenance.

Technical characteristics

- > Power supply 230 / 1 Ph / 50Hz.
- > Electric cubicle.
- > Limit switches as standard (2 steps).
- > IP 44 MR1 - IP 54 MR2 & 3.
- > Push button box with up/down button and emergency stop.
- > 3 meter control cable.

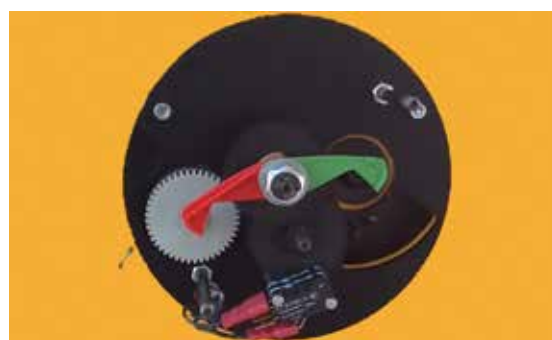

Limit switch very easy to adjust and extremely reliable.

| Type | Capacity at last layer (kg) | Capacity at first layer (kg) | Number of layers | Speed at first layer (m/min) | Speed at upper layer (m/min) | Motor power (kW) | Motor type | Max cable length (m) | Weight (kg) | Rope diameter (mm) |
|------|-----------------------------|------------------------------|------------------|------------------------------|------------------------------|------------------|-------------|----------------------|-------------|--------------------|
| MR1 | 150 | 150 | 3 | 5,5 | 7 | 0,25 | 1 Ph - 230V | 15 | 14 | 4 |
| MR2 | 300 | 300 | 3 | 4,6 | 5,9 | 0,37 | 1 Ph - 230V | 16 | 27 | 5 |
| MR3 | 500 | 500 | 3 | 2,6 | 3,6 | 0,37 | 1 Ph - 230V | 13,5 | 27 | 6 |

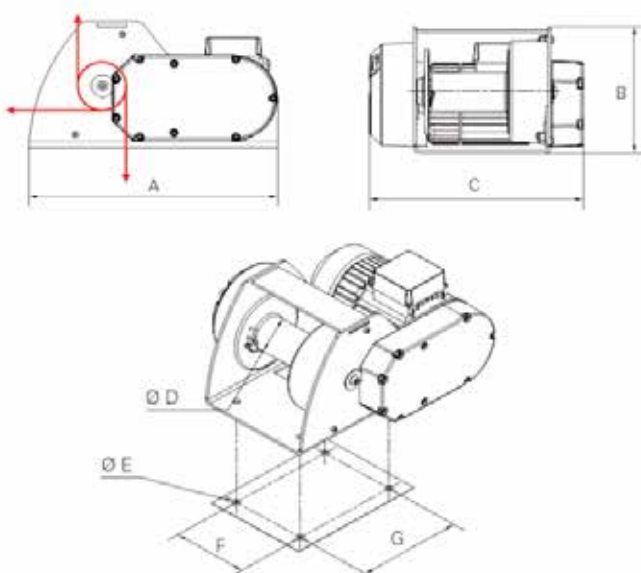

| Dimensions in mm | MR1 | MR2 | MR3 |
|------------------|-----|------|------|
| A | 310 | 390 | 390 |
| B | 179 | 205 | 205 |
| C | 281 | 341 | 341 |
| Diameter D | 54 | 63,5 | 63,5 |
| Diameter E | 9 | 13 | 13 |
| F | 114 | 144 | 144 |
| Diameter G | 154 | 200 | 200 |

Manual hoists and winches

Definition of winch : horizontal cylinder around which a rope or wire rope used to lift or pull a load is wound up.



VHR

ZHV

PLV

MV, ME & MT



VHR

Hand chain hoist for loads from 250 to 20,000 kg

Eye-pleasing, compact and efficient, the VHR is tested to all currently applicable standards.

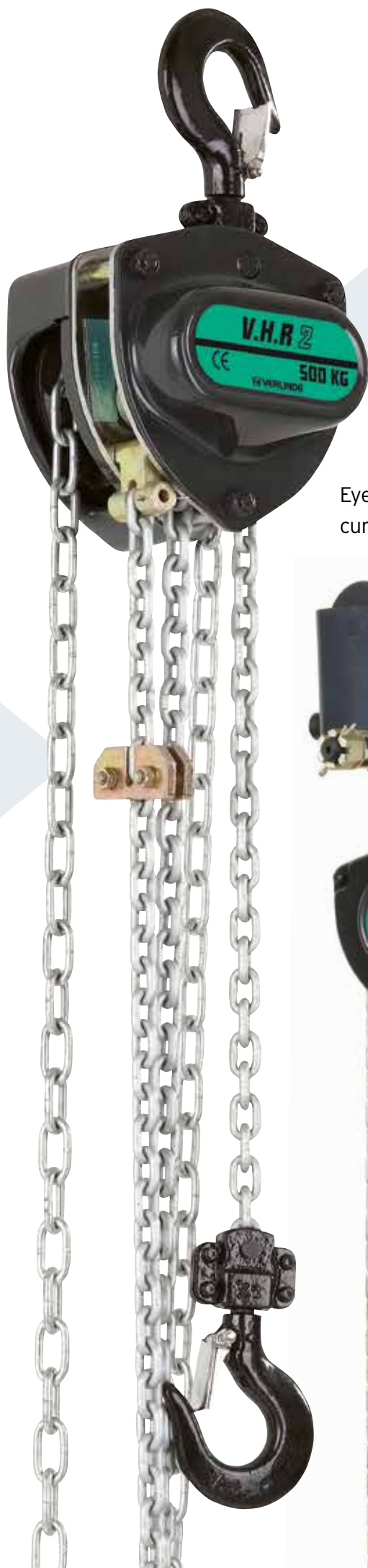

► Technical characteristics

- Machined chain sprocket and gears provide smoother, more efficient operation.
- Overload limiter as standard.
- 3 meters standard lift. Hand chain is 0.5 meters less than lift chain. Non-standard lifts available.
- High strength grade 80 alloy steel load chain with galvanized finish for corrosion resistance (comply with EN 818, safety factor 4).
- VHR's compact design offers safety together with reduced weight. Ideal for construction and maintenance applications.
- Rugged construction featuring steel gearcase and handwheel cover.
- Hooks are alloy steel, heat treated and equipped with hook latches and inspection points.

VHR

Overhung with trolley operated
by push action on load type CHD.



VHR

Overhung with travel trolley backed by handwheel and hand chain operation type CHDD (Spark proof version of hoist and trolley).



> Options available

A wide range of options is available for this hoist :

- > VHR with stainless steel load chain.
- > Chain bag.
- > VHR with trolley operated by push action on load.
- > VHR with short headroom trolley (HPR).
- > VHR version Ex - ATEX.
- > VHR Ex with Ex short headroom trolley (HPR).

VHR

Hand chain hoist in sparkproof version.



ZHV

Manual chain hoist for loads from 500 to 50,000 kg



► Technical characteristics

- > Epoxy Painting (min. 50 µm).
- > Machined chain sprocket and gears provide smoother, more efficient operation.
- > High strength alloy steel load chain with corrosion-resistant galvanized
- > Galvanized hand chain.
- > ZHV's compact design offers safety together with reduced weight. Ideal for construction and maintenance applications.
- > Steel casing solidly protects chain sprocket, gearcase and handwheel cover.
- > Upper and lower alloy steel ISO hooks with safety latches.
- > Delivered with CE certificate.

► Options available (according models)

- > ZHV with EX ATEX marking (bronze coated hook, polyester paint,...).
- > ZHV full stainless steel (hoist frame, chain, hook,...).
- > ZHV with Aluminum Ceramic Coat (min. 30 µm).
- > ZHV with Aluminum Ceramic Coat (min. 30 µm) and additional polyester paint.
- > ZHV with Offshore paint coating.
- > Locking device on trolley, activated by hand chain.
- > ZHV with normal headroom trolley (HPN).
- > ZHV with short headroom trolley (HPR).
- > ZHV with trolley for curved beam (HPNB).
- > ZHV with short headroom trolley (HPR).

Surface treatment definition

• **Aluminum Ceramic Coat.** This treatment consist into apply a thin layer of Aluminum Ceramic Coat (3 µm) on the components in order to allow an increase in the hardness of the order of 30GPa (pressure of 3 tons per mm²). The advantages of this ceramic surface treatment are :

- > Reduction of the friction between the parts between them for a increase the service life of parts.
- > A reduction of oxidation and corrosion.
- > A surface hardness.
- > Electrical isolation.

• **Aluminum Ceramic Coat and additional polyester paint.** This double treatment consists of depositing a layer of Pigmented polyester on the treatment ceramic in order to offer enhanced corrosion protection (Navy atmosphere).



ZHV with Aluminum
Ceramic Coat



Hand chain block EX
ATEX with coat of
polyester paint
and brass hook



ZHV full stainless steel
(500 & 1,000 kg)

ZHV-HPR



Hand chain block with low headroom trolley construction for loads from 1000 to 30,000 kg

Technical characteristics

- > Epoxy Painting (min. 50 µm).
- > Machined chain sprocket and gears provide smoother, more efficient operation.
- > High strength alloy steel load chain with corrosion-resistant galvanized.
- > Galvanized hand chain.
- > ZHV's compact design offers safety together with reduced weight.
- > Steel casing solidly protects chain sprocket, gearcase and handwheel cover.

- > Upper and lower alloy steel ISO hooks with safety latches.
- > Delivered with CE certificate.

Options available

- > See options of ZHV-CHZ.

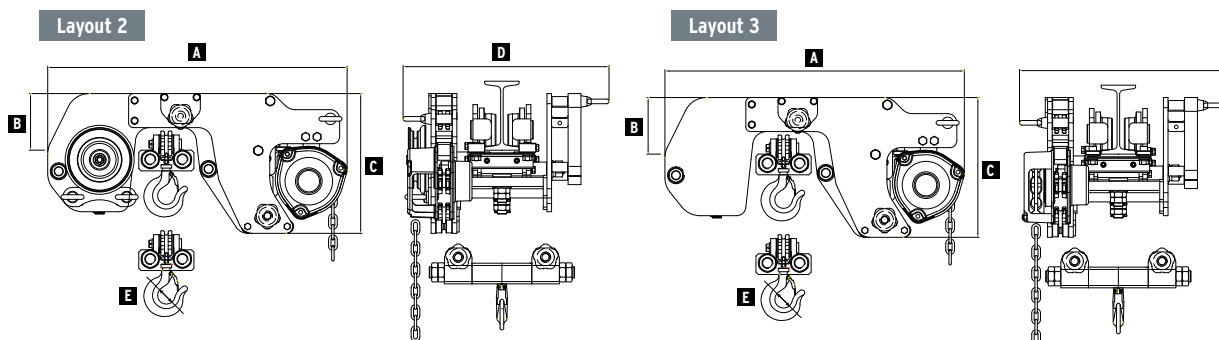
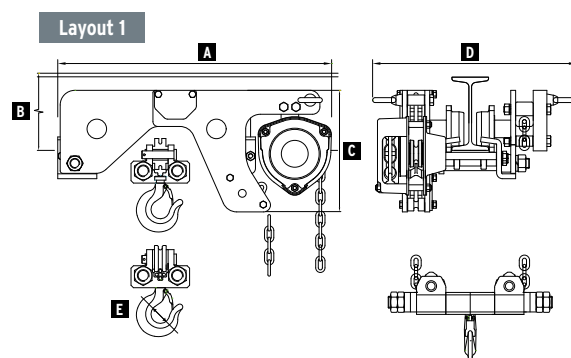

| Load (kg) | Dimensions in mm | | | | | Standard height of lift (m) | Length of hand chain (m) | Lifting chain size (mm) | Number of falls | Flange width (mm) | Min radius (mm) | Weight (kg) |
|---|------------------|-----|-----|-------|-----|-----------------------------------|-----------------------------|----------------------------|--------------------|-------------------------|-----------------------|----------------|
| | A | B | C | D | ØE | | | | | | | |
| Layout 1 : Hand chain block ZHV with short headroom push trolley (HPR) | | | | | | | | | | | | |
| 1000 | 561 | 150 | - | 418 | 38 | 2,5 | 2,0 | Ø 6,3 x P19,0 | 2 | 75 ~ 125 | 2900 | 61 |
| 2000 | 560,5 | 150 | 285 | 372,5 | 41 | 3,0 | 2,5 | Ø 7,1 x P20,2 | 2 | 75 ~ 150 | 3200 | 64 |
| Layout 2 : Hand chain block ZHV with short headroom geared trolley (HPR) | | | | | | | | | | | | |
| 1000 | 652 | 150 | 304 | 448 | 38 | 2,5 | 2,0 | Ø 6,3 x P 19,0 | 2 | 75 ~ 125 | 2900 | 59 |
| 2000 | 560,5 | 150 | 285 | 463 | 41 | 3,0 | 2,5 | Ø 7,1 x P 20,2 | 2 | 75 ~ 150 | 3200 | 63 |
| 3000 | 691 | 300 | 370 | 568 | 58 | 3,0 | 2,5 | Ø 7,9 x P 23,0 | 2 | 100 ~ 150 | 3500 | 150 |
| 5000 | 794 | 300 | 407 | 644 | 64 | 3,0 | 3,0 | Ø 11,1 x P 33,3 | 2 | 125 ~ 175 | - | 195 |
| 10000 | 995 | 350 | 643 | 640 | 86 | 3,5 | 3,5 | Ø 11,1 x P 33,3 | 4 | 150 ~ 190 | - | 460 |
| 20000 | 1460 | 285 | 660 | 1100 | - | 3,5 | 3,5 | Ø 11,1 x P 33,3 | 6 | 150 ~ 190 | - | 850 |
| 30000 | 1650 | 600 | 655 | 894 | 130 | 3,5 | 3,5 | Ø 11,1 x P 33,3 | 10 | 175 ~ 190 | - | 1320 |
| Layout : Hand chain block ZHV with short headroom geared trolley for curved beam (HPNB) | | | | | | | | | | | | |
| 1000 | 652 | 123 | 304 | 448 | - | 2,5 | 2,0 | Ø 6,3 x P 19,0 | 2 | 75 ~ 125 | 1000 | 98 |
| Layout 3 : Hand chain block ZHV with short headroom push trolley for curved beam (HPNB) | | | | | | | | | | | | |
| 1000 | 652 | 123 | 304 | 448 | - | 2,5 | 2,0 | Ø 6,3 x P 19,0 | 2 | 75 ~ 125 | 1000 | 93 |

PLV

Hand lever block for loads from 250 to 3,000 kg

The PLV is designed to lift, pull or drag loads. Its has application in every branch of industry through the ease with which it can be used and the many services it can provide at all times in the workshop, on the worksite,...

Technical characteristics

- > The 4 models are attractive, robust, compact, light and highly manoeurable.
- > The PLV can be oriented in any direction, the operator can select the lever position enabling him the greatest possible operational convenience.
- > PLV lever block are highly compact, thanks to the use of special steel.
- > The hand lever block is a new concept combining aesthetic appeal with reliability.
- > Chromium-plated hoist and lever.
- > Strengthened housing offers good protection for mechanisms.
- > The hand lever block offers a high level of safety with limited weight and routine maintenance.
- > Unclutching of chain when under no load.
- > The hand lever block was tested to approved standards, a test certificate and guarantee are supplied.
- > Heavy duty steel alloy hoisting chain.
- > Swivellable hooks with safety latches.



Load capacity

| | 250 kg | 750 kg | 1,500 kg | 3,000 kg |
|--------|--------|--------|----------|----------|
| > PLV1 | | | | |
| > PLV2 | | | | |
| > PLV3 | | | | |
| > PLV4 | | | | |

Winch type MV



Winch type ME



MV & ME

Endless screw winch
and geared winch
for loads from
250 to 3,000 kg

Technical characteristics

- > Encased mechanical parts.
- > Automatic brake.
- > Adjustable and dismountable crank.
- > 2 securing planes horizontal or vertical (according to model).

- > Highly rugged design, thanks to the exceptional rigidity of the frame.
- > Mechanical parts protected by cataphoresis.
- > Can be unclutched when off-load, whilst impossible to unclutch under load (except MV250).

| Model | ME2 | ME3 | ME4 | ME5 | MV1 | MV2 | MV3 | MV4 | MV5 | MV6 |
|-----------------------------------|----------------|-----|-------|-------|-----|-----|-------|-------|-------|-------|
| First layer lifting capacity (kg) | 300 | 500 | 1,000 | 2,000 | 250 | 500 | 1,000 | 1,500 | 2,000 | 3,000 |
| Total length of winding (m) | 38 | 18 | 30 | 25 | 15 | 18 | 30 | 23 | 17 | 18,5 |
| Maximum number of layers | 6 | 4 | 4 | 3 | 4 | 4 | 4 | 3 | 2 | 2 |
| Effort required on handle (daN) | 12,5 | 19 | 14,5 | 16,5 | 11 | 14 | 14 | 14 | 14,5 | 15 |
| Weight without cable (kg) | 15 | 15 | 44 | 83 | 7,5 | 12 | 37,5 | 52 | 80 | 140 |
| Max. and min. use temperature | -20°C to +40°C | | | | | | | | | |



MT

Manual winch
for loads from
150 and 300 kg

Technical characteristics

- > A new generation, compact winch taking advantage of the qualities of composite materials and aluminium, especially their anti-corrosion properties.
- > Easy to wind. Planetary reducer in a sealed casing.

- > Automatic brake.
- > With stainless steel spring and pawls.
- > Clutchable, vacuum drum, associated with a failsafe system in the rope wind direction (patented).
- > Removable crank. Ergonomically and comfortably shaped crank grip.
- > Large rope release range (more than 250°).

| Load capacity (kg) | Winding (m) | Winch type MT | Stainless steel and steel rope (mm) |
|--------------------|-------------|--|-------------------------------------|
| 150 | 24 | *Fixation plate, spring and radchet in stainless steel | 4 |
| 150 inox* | 24 | | 4 |
| 300 | 8,5 | | 5 |
| 300 inox* | 8,5 | | 5 |

Trolleys and accessories

Definition of Trolley : 4-wheeled carriage used to move loads.



CHD-CHDD
CHZ
CHZ INOX
CHV
PRD-PRV
PAP
LIMITER
PEV
EQUIBLOC
PAL



CHD-CHDD



CHD

Travel trolley operated by push action on load.

Manual travel trolley for loads from 250 to 20,000 kg



CHDD

Travel trolley operated by hand wheel and hand chain.



► Technical characteristics

- › The distance between flanges can be adjusted as required.
- › Travel movement is imparted either by pushing, or by handwheel and chain.
- › Delivered ready to assemble in individual boxes.



► Options available

- › Stainless steel load chain
- › Ex version with ATEX markings.
- › Chrome-plated version of trolley available.



► Load capacity

| | 250 kg | 500 kg | 1000 kg | 2000 kg | 3000 kg | 5000 kg | 6300 kg | 7500 kg | 10000 kg | 12500 kg | 16000 kg | 20000 kg |
|--------|--------|--------|---------|---------|---------|---------|---------|---------|----------|----------|----------|----------|
| › CHD | | | | | | | | | | | | |
| › CHDD | | | | | | | | | | | | |





CHZ

Manual travel trolley for loads from 1,000 to 10,000 kg

► Technical characteristics

- › Can be used with any type of overhead hooked lifting device.
- › Operated by directly pushing the load (CHZD models) or using a handwheel and chain (CHZDD models).
- › Epoxy Painting (min. 50 µm).
- › Easily adjustable to fit beams.
- › Steel rollers machined for smooth movement.
- › Trolley body made of high-resistance steel.

- › Rollers compatible with all sorts of I and H beams.
- › Wheel ball bearings are moisture-tight and maintenance free.
- › Galvanized hand chain on CHZDD type.
- › Loads up to 100 tons.
- › Delivered with CE certificate.

Locking device
on trolley



► Options available

- › Can be used with any type of overhead hooked lifting device.
- › Operated by directly pushing the load (CHZD models) or using a handwheel and chain (CHZDD models).
- › Epoxy Painting (min. 50 µm).
- › Easily adjustable to fit beams.
- › Steel rollers machined for smooth movement.
- › Trolley body made of high-resistance steel.

- › Rollers compatible with all sorts of I and H beams.
- › Wheel ball bearings are moisture-tight and maintenance free.
- › Galvanized hand chain on CHZDD type.
- › Loads up to 100 tons.
- › Delivered with CE certificate.



CHZ INOX

Stainless steel trolley
for loads from
500 to 1,000 kg



Technical characteristics

- › CHZ INOX trolley totally Stainless steel : End plate, suspension beam, load wheel.
- › The CHZ INOX trolley may be used with any type of manual lifting equipment fitted with a hook.
- › Push travel trolley.
- › Stainless steel load wheel made on machine center for smooth motion.
- › Stainless steel load wheel compatible with all type of profile I or H.
- › Bearing are dust protected and maintenance free.
- › Serial number on plate fixed on the frame.
- › CE certificate.
- › Surface Treatment : Electrolytic Polishing.

Options available

- › ZHV INOX hand chain block.
- › Setting of beam width.

Material list

- › Plate and Toller : SUS304.
- › Bearing : SUS420.
- › Name Plate : SUS316.

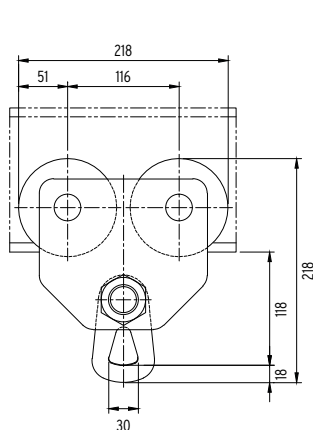

CHZ
500 kg

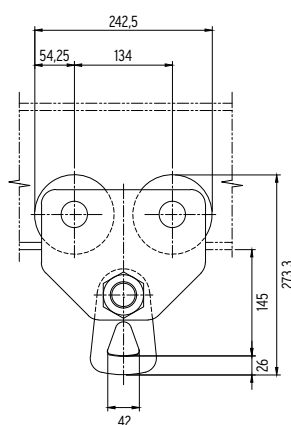
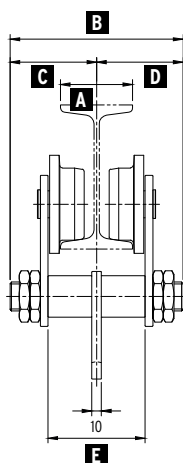

CHZ
1000 kg

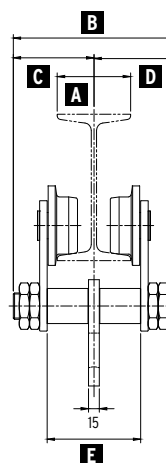

| Load (kg) | Dimensions in mm | | | | | Min. distance from hook to traversing beam (mm) | Beam width (mm) | Min Radius (mm) | Weight (kg) |
|--------------|------------------|-----|-------|-------|-----|---|--------------------|--------------------|----------------|
| | A | B | C | D | E | | | | |
| 500 | 75 | 180 | 90 | 90 | 101 | 118 | 64 | 1200 | 10,5 |
| | 100 | 205 | 102,5 | 102,5 | 126 | 118 | 64 | 1200 | 10,5 |
| | 125 | 230 | 115 | 115 | 151 | 118 | 64 | 1200 | 10,5 |
| 1000 | 100 | 220 | 110 | 110 | 128 | 145 | 82 | 1300 | 15,8 |
| | 125 | 245 | 122,5 | 122,5 | 153 | 145 | 82 | 1300 | 15,8 |
| | 150 | 270 | 135 | 135 | 178 | 145 | 82 | 1300 | 15,8 |



CHVX



Electric variable speed travel trolley for loads of 63 to 3,200 kg

Designed to roll on all profiles type IPN or IPE, HEA or HEB, both straight or curved, the VERLINDE CHVX electric trolley enables a hoist with a top hook or EUROCHAIN VX hoist coupling systems to be hung directly.

► Technical characteristics

- › The CHVX enables any type of hoisting device to be hung.
- › Variable travel movement speed 5 to 20 m/min.
- › Gap between flanges adjustable enabling it to be adapted to all types of IPN, IPE, HEA or HEB straight or curved profiles.
- › Protection is IP66 in standard.
- › Class F motor protection system.
- › 4 rubber stops.
- › Trolley delivered non assembled.
- › Low voltage electrical cabinet.

► Options available

- › Worm gear box to obtain reduced side dimension (5 or 10 m/min and 10-2.5 m/min).
- › Dual travel speed 20 & 5 m/min (contactor control).
- › Additional hand chain for hand driven trolley.
- › Travelling limit switch with different setting.
- › Special power supply, special control voltages.
- › Control pendant with 2,5 m cable.
- › Additional meter pendant control cable.
- › 4-button pendant for hoist to replace standard 2-button pendant.
- › Rain cover.
- › Counter wheels.
- › Counterweights.



| S.W.L. (kg) | Trolley type | Flange (Min-max) | Beam height min. (mm) |
|--|--------------|------------------|-----------------------|
| CHVX-trolley without motor ("push" version) | | | |
| 63 → 1000 | M10 | 200 → 300 mm | 120 |
| 1000 → 3200 | M32 | 200 → 300 mm | 140 |
| CHVX-trolley with motor | | | |
| 63 → 1000 | M10 | 200 → 300 mm | 120 |
| 1000 → 3200 | M32 | 200 → 300 mm | 140 |

| Hoist type | CHVX10* Min curve radius : 2000 mm | CHVX32* Min curve radius : 2000 mm |
|----------------|---------------------------------------|---------------------------------------|
| EUROCHAIN VX2 | 63 kg ≤ x ≤ 500 kg | – |
| EUROCHAIN VX5 | 160 kg ≤ x ≤ 1 000 kg | – |
| EUROCHAIN VX10 | – | 500 kg ≤ x ≤ 2500 kg |

*Not available if used with inverter trolleys with an auto transformer (208/230/575V).



PRD-PRV

Trolleys designed for hand-operated articulated sliding girders system for loads from **250 to 2,000 kg**



Trolleys designed for electrically powered articulated sliding girders for loads from **250 to 2,000 kg**

The ideal solution for hand-operated articulated sliding girders with spans of up to 12 metres. The PRD offers a low-cost solution for moving loads of 250 to 2,000 kg by pushing them along any type of monorail type steel section.

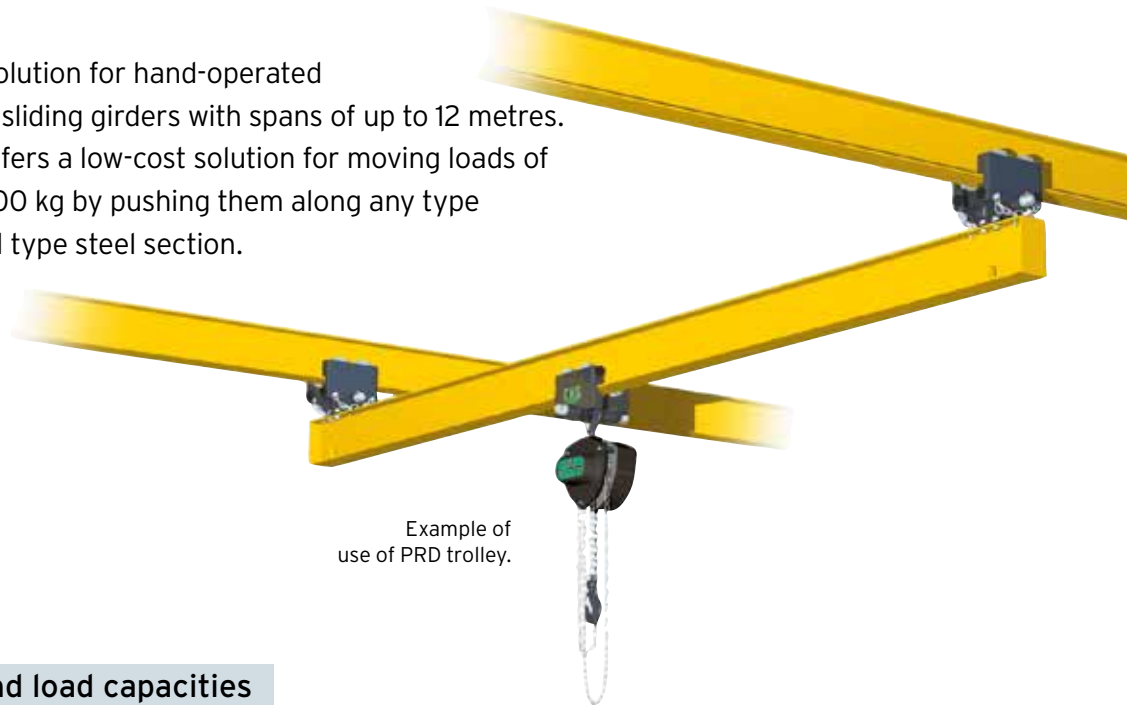

Example of use of PRD trolley.

Span and load capacities

| | 1m | 2m | 3m | 4m | 5m | 6m | 7m | 8m | 9m | 10m | 11m | 12m |
|------------|-------------|-------------|-------------|-------------|-------------|-------------|-------------|-------------|-------------|-------------|-------------|-------------|
| > 250 kg | PRD1 / PRV1 | PRD1 / PRV1 | PRD1 / PRV1 | PRD1 / PRV1 | PRD1 / PRV1 | PRD1 / PRV1 | PRD1 / PRV1 | PRD1 / PRV1 | PRD1 / PRV1 | PRD1 / PRV1 | PRD1 / PRV1 | PRD1 / PRV1 |
| > 500 kg | PRD1 / PRV1 | PRD1 / PRV1 | PRD1 / PRV1 | PRD1 / PRV1 | PRD1 / PRV1 | PRD1 / PRV1 | PRD1 / PRV1 | PRD1 / PRV1 | PRD1 / PRV1 | PRD2 / PRV2 | PRD2 / PRV2 | PRD2 / PRV2 |
| > 1 000 kg | PRD1 / PRV1 | PRD1 / PRV1 | PRD1 / PRV1 | PRD1 / PRV1 | PRD1 / PRV1 | PRD1 / PRV1 | PRD1 / PRV1 | PRD2 / PRV2 | PRD2 / PRV2 | PRD2 / PRV2 | PRD3 / PRV3 | PRD3 / PRV3 |
| > 1 600 kg | PRD1 / PRV1 | PRD1 / PRV1 | PRD1 / PRV1 | PRD1 / PRV1 | PRD1 / PRV1 | PRD2 / PRV2 | PRD2 / PRV2 | PRD2 / PRV2 | PRD2 / PRV2 | PRD2 / PRV2 | PRD3 / PRV3 | PRD3 / PRV3 |
| > 2 000 kg | PRD1 / PRV1 | PRD1 / PRV1 | PRD1 / PRV1 | PRD1 / PRV1 | PRD2 / PRV2 | PRD2 / PRV2 | PRD2 / PRV2 | PRD2 / PRV2 | PRD2 / PRV2 | PRD2 / PRV2 | PRD3 / PRV3 | PRD3 / PRV3 |

PRD1 / PRV1
PRD2 / PRV2
PRD3 / PRV3

PAP

Girder clamp
for loads from
1,000 to 5,000 kg



The PAP enables a lifting device to be hooked in fixed position from a girder, an attachment point for hoisting profiles, installation of mechanical limit switch (stop) at low cost... Its applications are limited only by your imagination !



| Model | Capacity (kg) | Distance (mm) | Weight (kg) |
|-------|---------------|---------------|-------------|
| PAP 1 | 1 000 | 75 - 230 | 4 |
| PAP 2 | 2 000 | 75 - 230 | 5 |
| PAP 3 | 3 000 | 80 - 310 | 9 |
| PAP 5 | 5 000 | 90 - 310 | 11 |



LIMITER

Range of load limiters for wire rope and chain hoists for loads from 60 to 37,500 kg

Why are load limiters needed ? Load limiters prevent accidents when the hoisted weight dangerously exceeds the rated values set by the maker or user of the equipment : it is a vital element to ensure the safety of operations personnel.



Load limiter for wire rope hoists with installation requiring no disassembly of the rope.



Load limiter for chain hoists.



Load limiter for wire rope hoists.

PEV

Electronic force gauges with digital readout for loads from 200 to 32,000 kg



VERLINDE offers a comprehensive range of compact electronic force gauges fitted with LCD or LED displays showing the load on hook in real time.

► Technical characteristics

- › Precision is +/- 0,1% of rated capacity.
- › Standard functions : overload signal (110% of max. load), calibration.
- › Reset, Total, complete deletion (except PEV 1 where "total" and "complete deletion" are options).
- › Excellent legibility with large size display (LCD or LED).
- › Readings are logged.
- › Working temperature -20° to +60° C.
- › Protection : IP 55.
- › Delivered with 2 shackles and top and bottom mounting hardware.
- › Delivered with rechargeable batteries and charger.



► Options available

- › Large-sized display.
- › 25,4 mm digit on 5 LED display.
- › Infra-red remote control.
- › Preselection of load.
- › Intensive use batteries.
- › Tropicalisation and IP 65 protection.
- › Stainless steel version of gauge available.
- › Printer integrated in gauge.
- › Radio link.



EQUIBLOC

Range of load
balancers for loads
from 0,7 kg to 55 kg

The EQUIBLOC frees the working area on assembly lines where a considerable number of tools have to be used and keeps effort to a minimum in workshops where heavy tools have to be used.



EQUIBLOC *AIR*

Range of air load balancers for loads from 70 to 350 kg*

With EQUIBLOC AIR®, a full range of pneumatic load balancers, VERLINDE offers comprehensive lifting and handling solutions for industry.

► Technical characteristics

VERLINDE, EQUIBLOC AIR® pneumatic load balancers come with the following standard equipment : lift and lowering control circuit, 6m of cable, spiral flexible control conduit, valve-box type control interface and an automatic hook.

The following special safety features are also standard : pneumatic measurement load balancing, lift and lowering control unit with balancer mode switch, under-load detection, grip locks (where applicable) if load is lift and with safety valve to keep pressure in tank if the control tube is cut.

The EQUIBLOC AIR® range includes five models of load balancers for loads from 70 kg à 350 kg*.



► Options available

- > Different trolley types depending on beam used (eg -beam or profile type EUROSISTEM aluminum)
- > Rigid suspension systems
- > Pneumatic tubing
- > Tube carrier trolleys
- > Load gripping tools (eg mechanical, vacuum, magnetic) according to your specifications
- > Special models available suitable for use in hazardous areas (Zones 1 or 21)

► Range

| Type | Control type | Lifting capacity* | Lifting height | Piston diameter | Piston length | Weight** |
|----------------------|-------------------|-------------------|----------------|-----------------|---------------|----------|
| VEA 70-2000B | DPLSK-SP-BLIL- HS | 70 kg | 2000 mm | 160 mm | 520 mm | 27 kg |
| VEA 120-2000B | DPLSK-SP-BLIL- HS | 120 kg | 2000 mm | 200 mm | 520 mm | 35 kg |
| VEA 120-3000B | DPLSK-SP-BLIL- HS | 120 kg | 3000 mm | 250 mm | 520 mm | 40 kg |
| VEA 160-2000B | DPLSK-SP-BLIL- HS | 160 kg | 2000 mm | 250 mm | 520 mm | 40 kg |
| VEA 225-1800B | DPLSK-SP-BLIL- HS | 225 kg | 1800 mm | 250 mm | 520 mm | 42 kg |
| VEA 350-1200B | DPLSK-SP-BLIL- HS | 350 kg | 1200 mm | 250 mm | 520 mm | 40 kg |
| VEA 350-2000B | DPLSK-SP-BLIL- HS | 359 kg | 2000 mm | 250 mm | 720 mm | 45 kg |

* Lifting capacity with 7 bar input pressure, measured at the balancer piston.

** Weight without control circuit and trolley.

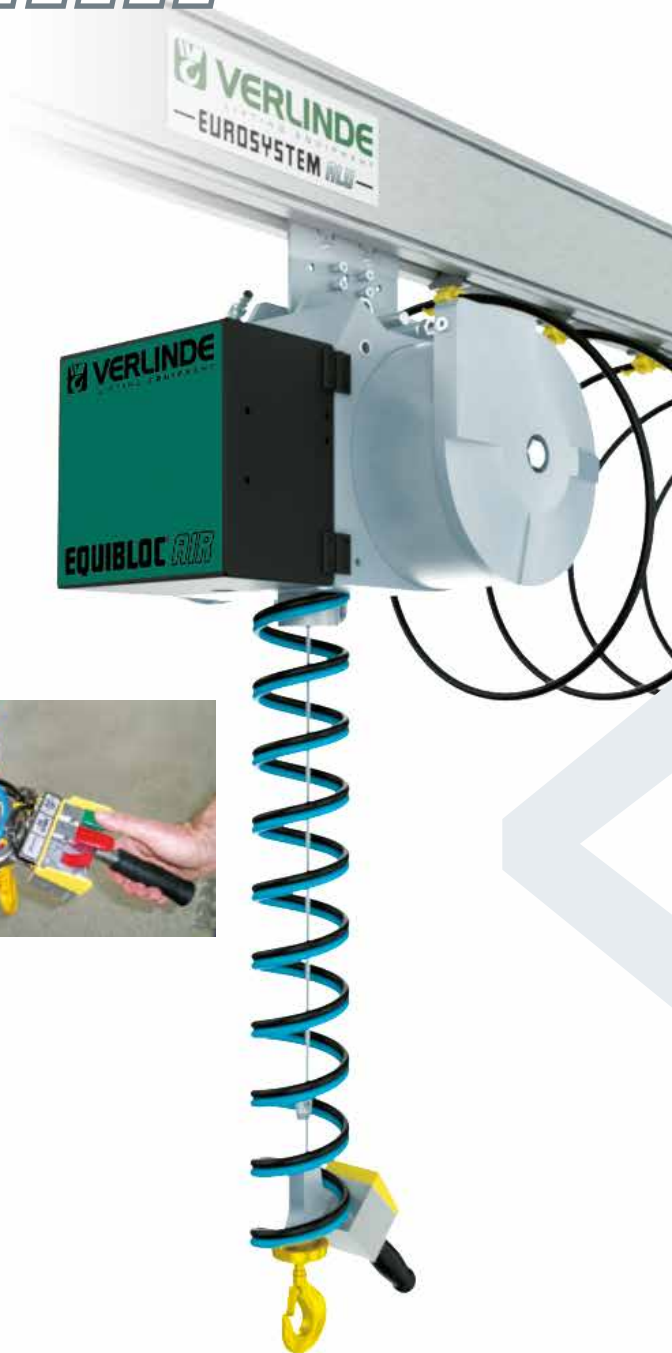

PAL P2R ALU

with central hanging and
2 adjustable lifting points.



PAL

Range of lifting
beams for loads from
125 to 10,000 kg

PAL P2F

with central hanging and
2 permanent lifting points.



PAL P2R

with central hanging and
2 adjustable lifting points.



PAL P4F

H-type central hanging and
4 permanent lifting points.



PAL P4R

"H" type with central hanging
and 4 adjustable lifting points.

► Technical characteristics

- > Rupture safety factor : 5.
- > The PAL line is manufactured to standard NFE 52210 and classed category FEM 5.
- > No load bearing welds.
- > Anti-rust treatment and RAL1028 glycerine paint finish.
- > Standard equipment: bow shackles, reel hooks and safety latches.
- > EC certificate of compliance.
- > User manual.

► Options available

- > "Y" type models with 3 hoisting points or or "X" type with 4 hoisting points available on request.
- > Galvanized lifting beams.
- > Special lifting beams with fork gripping system for pallets.
- > Lifting beams for Big Bag system.
- > Special aluminium lifting beams for light hoists.

| Model | Capacity (kg) | Span (m) |
|----------|---------------|----------|
| P2F | 1000 to 10000 | 1 to 6 |
| P2R | 1000 to 10000 | 0,5 to 6 |
| P4F | 1000 to 10000 | 1 to 4 |
| P4R | 1000 to 10000 | 1 to 4 |
| P2F ALU | 125 to 2000 | 1 to 6 |
| P2R ALU | 125 to 2000 | 1 to 6 |
| P4HF ALU | 125 to 2000 | 1 to 4 |
| P4HR ALU | 125 to 2000 | 1 to 4 |

Jib cranes, gantry cranes and travelling cranes

Jib crane. Definition : a support column with a cross-member at right angles.



EUROSYSTEM
EUROSTYLE
GANTRIES CRANES
MANUAL CRANES
EUROPONT
COMPOSANTS +



EUROSYSTEM *STD*

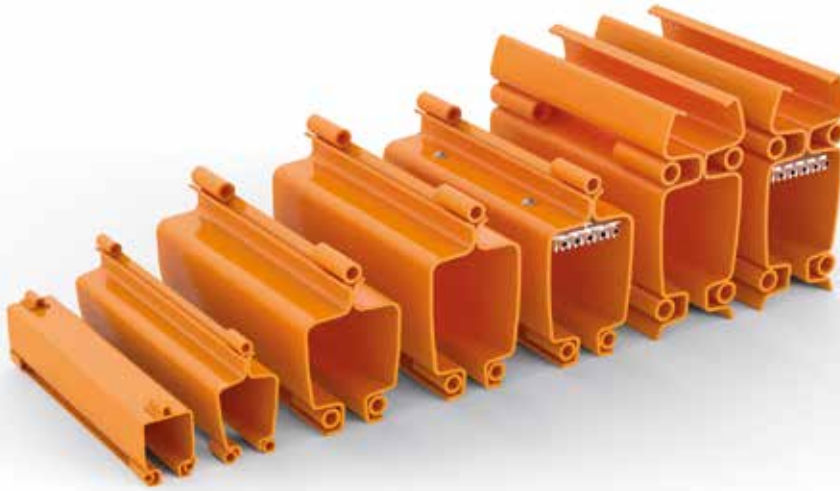

Overhead
handling system
in **steel profile**
for loads up
to **2,000 kg**

Load capacity of up to 2,000 kg according to profile. The basic component of the overhead handling system is a cold-formed high strength hollow steel profile that provides an extremely uniform surface.

The closed structure of the profile makes it possible to keep the inside of the runway clean.

> Undeniable advantages

- > The loads are easy to handle, thanks to an excellent rolling coefficient.
- > Numerous types of fixation, adaptable to any structure.
- > Installations are pleasing to the eye.
- > The load on the bearing structure is kept to a minimum through the pendular design of the system.
- > Monorail tracks, runways and circuits easily extended thanks to the system's modularity.
- > Maintenance is practically zero.
- > Great flexibility.
- > Minimum loss of headroom.
- > Installation and fixation by simple bolting.

> Technical characteristics

- There are 5 sizes in the range of profiles that can be selected depending on the load capacity and the distance between the suspension points:
- > STD II-H-R is the strengthened version of the STD II profile with integrated power supply (5 pole conductor).
 - > STD II-H is the strengthened version of the STD II profile for loads of up to 3,200 kg.
 - > STD II-R is the STD II profile version with integrated power supply (5 pole conductor).
 - > STD II for loads of up to 2,000 kg.
 - > STD II-L for loads of up to 1,000 kg.
 - > STD I for loads of up to 500 kg.
 - > STD 100 for loads of up to 125 kg.



> Single-beam suspension crane, electric travel and cross-travel, **rigid structure**.



► Single-beam encasted crane with electric travel and cross-travel, **rigid structure**.

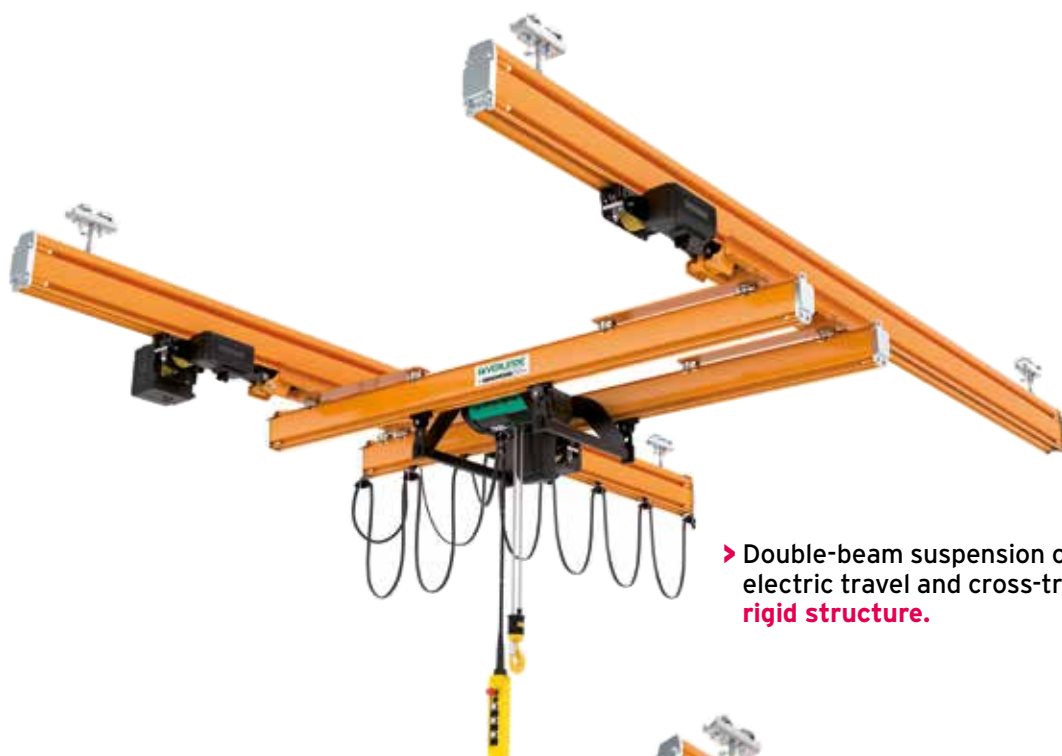

► Double-beam suspension crane, electric travel and cross-travel, **rigid structure**.

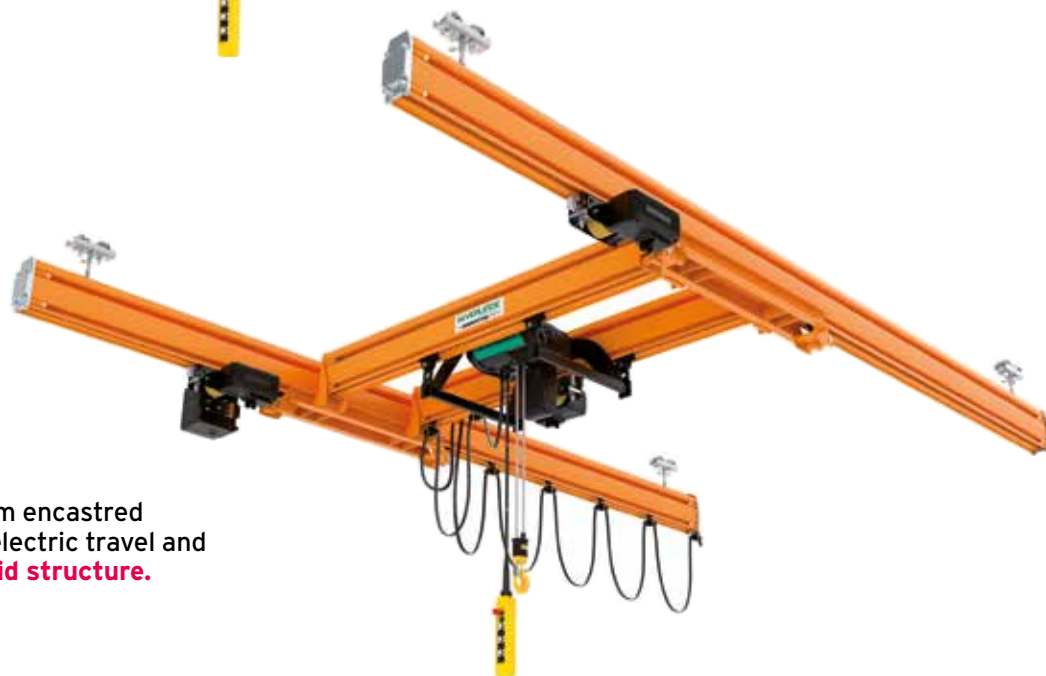

► Double-beam encasted crane with electric travel and transfer, **rigid structure**.



EUROSYSTEM *ALD*



Aluminium
hollow profile for
overhead handling
system with loads
of 60 to 2,000 kg

Load capacity of up to 2,000 kg according to profile. The basic component of the overhead handling system is a cold-formed high strength hollow steel profile that provides an extremely uniform surface.

The closed structure of the profile makes it possible to keep the inside of the runway clean.

► Undeniable advantages

Eurosystem ALD Aluminium represents a new generation of hollow profile handling systems. This innovative solution presents the combined advantages of conventional steel and aluminium hollow profile. Steel and aluminium profile may be combined. Similar advantages coming from Steel with benefits from Aluminium.

- **ERGONOMIC.** Light rails means users can very easily and effortlessly handle heavy and cumbersome loads.
- **ACCURATE.** Accuracy is ensured through high quality manufacture and smooth movements.
- **ANTICORROSION.** The aluminium profiles are externally and internally anodised.
- **SAFETY.** The beam is guaranteed without welding.
- **TECHNOLOGICAL.** The beam is the result of the latest innovations in cold extrusion and structure optimisation.
- **PRACTICAL.** The beam is compatible with all ITEM standard accessories.
- **LASTING.** Strong resistancy to wear and tear is the result of anodisation and the roller materials.
- **SILENCE.** Operates silently due to the precise manufacture of the movement surface.

► Technical characteristics

There are 4 sizes in the range of profiles (2 of them available with integrated power supply), that can be selected depending on the load capacity and the distance between the suspension points:

- A 22 R is the strengthened version of the ALD A22 profile with integrated power supply (5 pole conductor).
- A 22 for loads of up to 2,000 kg.
- A 18 R is the strengthened version of the ALD A18 profile with integrated power supply (5 pole conductor).
- A 18 for loads of up to 1,000 kg.
- A 16 for loads of up to 500 kg.
- A 12 for loads of up to 500 kg.

► Numerous possibilities

This range of profiles associated with other components like suspensions, manual or electric travelling trolleys and cross travel trolleys enable many lifting solutions to be implemented.

- Monorail tracks.
- Runways.
- Single girder overhead cranes.
- Double-beam overhead cranes.
- Telescopic beams.

- Single-beam suspension crane with manual travel and cross-travel, **articulated structure**.



- Double-beam suspension crane with manual travel and cross-travel, **articulated structure**.



EUROSTYLE

Range of manual and motorized jib cranes



Handling facilities made-to-measure for each workstation is indispensable and enables production halts caused by using the overhead travelling crane in service in the workshop to be avoided. VERLINDE offers you a wide choice of rugged, eyepleasing designs and high performance jib cranes equipped with the full range of EUROCHAIN VX, EUROBLOC VT or EUROLIFT BH hoists. Whether wall-mounted or on mast posts, jib cranes are rational and low-cost handling facilities the installation of which does not require any modifications to the building. They are compact, whilst at the same time enabling loads to be moved in every direction. They can be used in every sector of industry : foundry, boilerplating, mechanical engineering, papermaking, etc. They are the ideal companion for overhead travelling cranes covering the workshop as a whole. They increase the autonomy and efficiency of every workstation.

► Technical characteristics

- > All-steel design in compliance with DIN 15018 standards.
- > IPE section or EUROSISTEM hollow section jib arm, withstanding torsional stresses.
- > Manual trolley with underhung hoisting tackle delivered as standard equipment on hollow section boom.
- > Service temperature: -10° to +40° C.
- > Presentation : shot-peened frame, primer coat and glossy yellow topcoat.
- > 24-months warranty on the paintwork in accordance with Re3 check procedure.
- > IP54 switchgear.

The characteristics of all our cranes (overall dimensions, weight, boom length and foundations) are indicated in our technical sheets.

► Made-to-measure configurations

► Wall-mounted (secured to the wall or a mast post).

Triangular design



VATS

63 à 2 000 kg - Portée de 2 à 8 m suivant la charge

Boom in EUROSYSTEM ST type hollow profile.

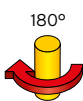

VAT

125 à 2 000 kg - Portée de 2 à 8 m suivant la charge

IPE section boom.

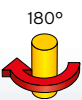

VATAL

125 à 2 000 kg - Portée de 2 à 8 m suivant la charge

Boom in EUROSYSTEM ALU type hollow profile.

Inverted design



VAI

125 à 4 000 kg - Portée de 2 à 7 m suivant la charge

IPE section boom.

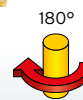

► Column mounted partially slewable.

Triangular design



VFTS

63 à 2 000 kg. Portée de 2 à 8 m suivant la charge. Hauteur sous fer : 2,5 m.



Boom in EUROSYSTEM ST type hollow profile.

VFT

125 à 2 000 kg. Portée de 2 à 8 m suivant la charge. Hauteur sous fer : 2,5 m.

IPE section boom.



VFTAL

63 à 2 000 kg. Portée de 2 à 8 m suivant la charge. Hauteur sous fer : 2,5 m.



Boom in EUROSYSTEM ALU type hollow profile.

Inverted design



VFI

125 à 2 000 kg. Portée de 2 à 7 m suivant la charge. Hauteur sous fer : 3 m.



IPE section boom.

► Column mounted 360° slewable.



Manually slewable

VFP

125 à 10 000 kg. Portée de 2 à 12 m suivant la charge. Hauteur sous fer : 3 m.

Option : Motorisation potence VFM

IPE section boom.

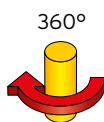

EUROSTYLE

"Templier" type manual jib cranes with articulated arms

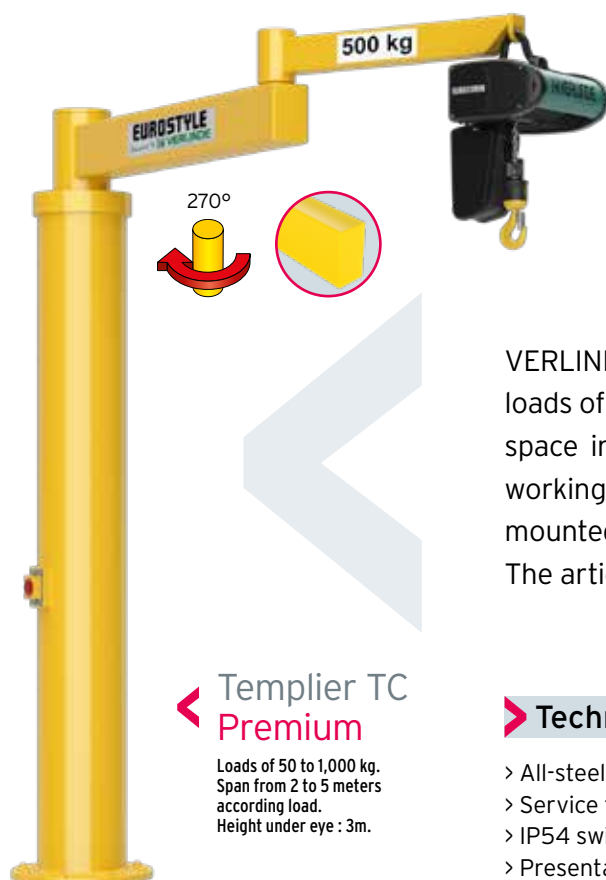

Templier TC Premium

Loads of 50 to 1,000 kg.
Span from 2 to 5 meters
according load.
Height under eye : 3m.

VERLINDE articulated crane is designed for handling loads of 50 to 1,000 kg with ease, taking up very little space in an almost circular area. Practically all the working zones afford access to the hoisting tackle mounted at the tip of the boom.

The articulated arm enables obstacles to be avoided.

Technical characteristics

- > All-steel design in compliance with DIN 15018 standards.
- > Service temperature : -10° to +40° C.
- > IP54 switchgear.
- > Presentation : shot-peened frame, primer coat and glossy yellow topcoat.

The characteristics of all our cranes (overall dimensions, weight, boom length and foundations) are indicated in our technical sheets.

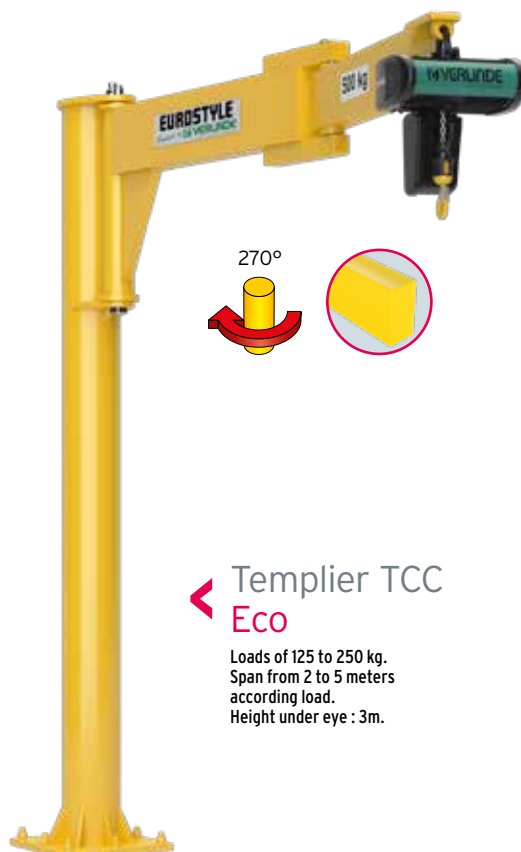

Templier TCC Eco

Loads of 125 to 250 kg.
Span from 2 to 5 meters
according load.
Height under eye : 3m.

Jib crane mounted on column.

Entirely independent from the building, anchored to the ground. This crane can serve an almost circular working area with a maximum radius of 5 meters.

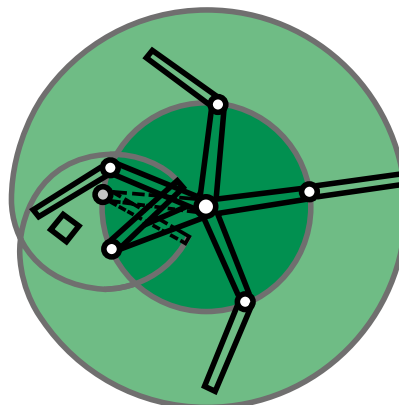

Working radius of
"Templier" jib crane.

Jib crane mounted on bracket.

This crane serves an almost circular working area with a radius of 5 meters (secured to a wall or mast post).

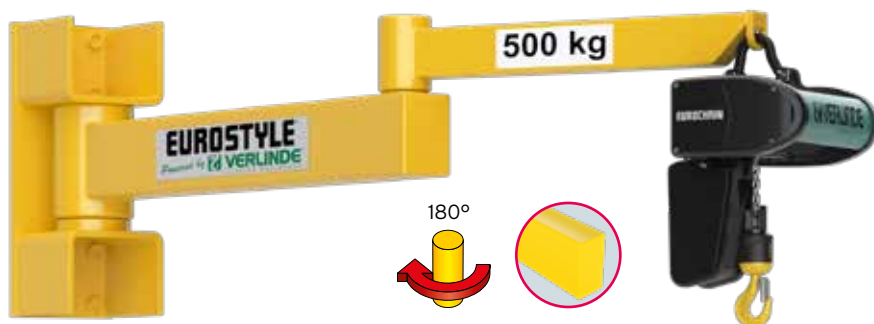

Templier TA Premium

Loads of 50 to 1,000 kg.
Span from 2 to 5 meters according load.

Templier TCA Eco

Loads of 125 to 250 kg.
Span from 2 to 5 meters according load.

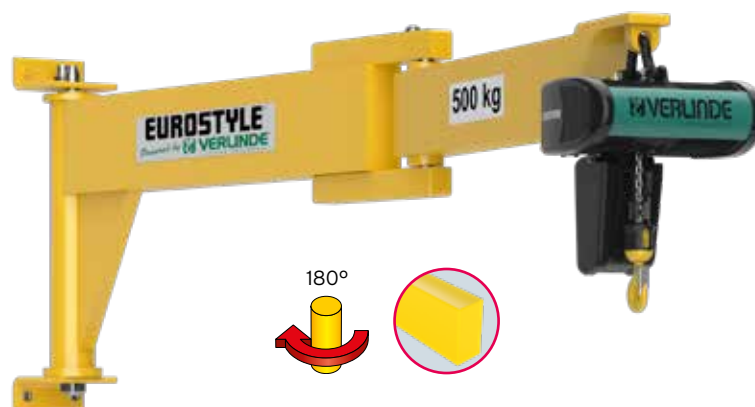

Jib crane mounted on roof.

This crane can serve an almost circular working area with a radius of 5 meters (secured to a ceiling or members of the structural frame of the building).

Templier TSR Premium

Loads of 500 to 1,000 kg.
Span from 2 to 5 meters according load.

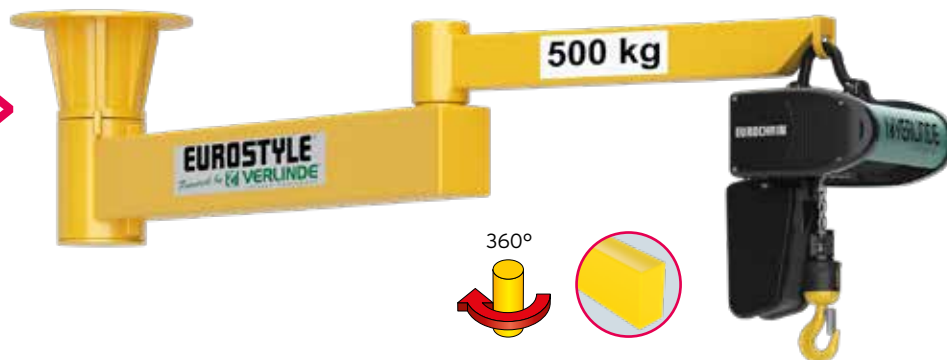

Options available on Eurostyle jib crane range

- > 20A Main switch.
- > 32A Main switch.
- > Rising cable.
- > Rotation slowing device.
- > Rotation stops.
- > Adjustable rotation stops a = 100 mm.
- > Adjustable rotation stops a = 130 mm.
- > Adjustable rotation stops a = 180 mm.
- > Adjustable rotation stops a = 210 & 250 mm.
- > Adjustable rotation stops a = 330 mm.
- > Adjustable rotation stops a = 380 mm.
- > Adjustable rotation stops a = 420 & 1 < 150 mm.
- > Hoists adjustable stops.
- > INOX single-position rotation lock.
- > Stainless steel multi-position rotation lock.
- > Stainless steel axis.
- > Sealing of the axis.
- > Indoor paint other color than RAL 1028.
- > Polyurethan painting RAL1028 on epoxy primer for outdoor use.
- > Polyurethan paint with specific RAL on epoxy primer for outdoor use.
- > Hot dip galvanizing (up to 6 m).
- > Rigging ring.
- > Covering for hand chain block.
- > Covering for electric chain hoist
- > Covering for electric chain hoist + head of slewing.
- > Covering for electric wire rope hoist + head of slewing.
- > Cover for main switch.
- > Motorization.
- > Calculation note.
- > Additional cable trolley for beam made out i-beam or steel and aluminium profile.
- > Steel base column jib crane.
- > Others type of packing - Export.



EUROSTYLE

H₂O range

Aluminium and galvanized jib cranes for water treatment systems.

Ideal for operations in used water treatment stations or at shore sites, EUROSTYLE H2O jib cranes are easily transported and manoeuvred by one person. Furthermore, they are dismantlable to be moved from one base to another.



EUROSTYLE
ALUMINIUM
VEFP

360°



► Technical characteristics

- › Aluminium dismantlable jib crane, 360° slewable.
- › Span adjustable to radius of 1.50 m.
- › 300 or 500 kg load range (according to model).
- › 3 or 4 elements make up the jib crane, very fast assembly.
- › Can be easily moved about and stored using the carry bag(s).
- › Slewing system is highly flexible by means of the swivel mounted in bearings.
- › RAL powder-coated on anodized surface (very robust and shock-resistant).
- › 2 different heights available by means of 2 extension pieces of different lengths (delivered as standard).
- › Supplied with 2 stainless steel shackles for securing lifting block or accessory.

► Options available

- › Manual VHR type load lifting hoist.
- › Manual winch system as standard for load lifting.
- › Wide range of aluminium, stainless steel or galvanized bases to be fixed to floor or wall.
- › Mounting hardware kit.
- › Jib crane frame riser with different heights.

Gantry cranes

Range of movable gantries for loads from 250 to 5,000 kg

With this line of VERLINDE independent manual gantries, maintenance services, assembly teams and any artisan mechanic will be able to carry out mounting, dismounting operations, and position parts or assemblies. This line of standard gantries is designed to receive all types of hoisting device. The VERLINDE gantry can be equipped with manual or electrically-powered chain tackle.



VGI gantry crane

For loads from 500 to 5,000 kg

Technical characteristics

- > The extreme mobility and stability on all surfaces provided by means of four caster wheels fitted with ball bearings on the shafts and king pins. These wheels formed from acetyl resin have excellent shock behaviour and ability to withstand attack by chemicals.
- > The raceway is a weld-fabricated IPE profile designed to accommodate a lifting and traversing movement device, with two traversing breast-pieces. The unit is finished in RAL 1028 polyurethane lacquer. Fully dismantlable, the VERLINDE independent gantries adapt to your need to make best use of workshop space.
- > The gantry is delivered disassembled, together with its galvanised boltwork and takes little time to assemble and commission.
- > A 3-piece dismantled weld fabricated package.
- > The gantries can be moved loaded on a smooth, clean floor.

Load capacity

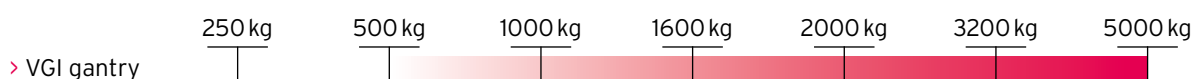



VGIM motorized gantry crane
For loads from 1,000 to 6,000 kg

> Technical characteristics

- > VERLINDE workshop motorized gantry crane for indoor and outdoor use.
- > The VGIM gantry can be moved loaded on a smooth, clean floor.
- > Mechanic-welded construction.
- > 2 motorized non swivel polyurethane wheels.
- > 2 castor polyurethane wheels.
- > Electrics in cubicle with movable pendant (low voltage control 48V).
- > Dual travelling speed 10 m/min & 20 m/min with inverter.
- > Swiveling of the gantry by inversions of the two motors.
- > Self rotating with 2 speed.
- > Reversing switch on the pendant.
- > 4 full stops.
- > Protection : 3 layers.
- > RAL 1028 yellow polyurethane finish.
- > Maximum hoisting speed = 16 m/min.
- > Maximum travelling speed = 10 m/min.

> Options available

- > Main switch.
- > Power feeding line.
- > Reel 18 m P < 2 kW.
- > Reel 18 m P < 7 kW.
- > Locking on wheel.

> Load capacity

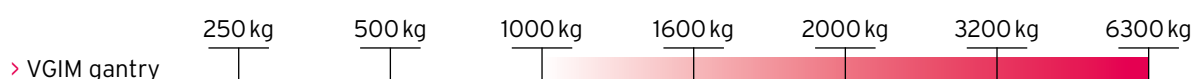

VGPS gantry crane

For loads from 500 to 2,000 kg

Option :
isolating switch

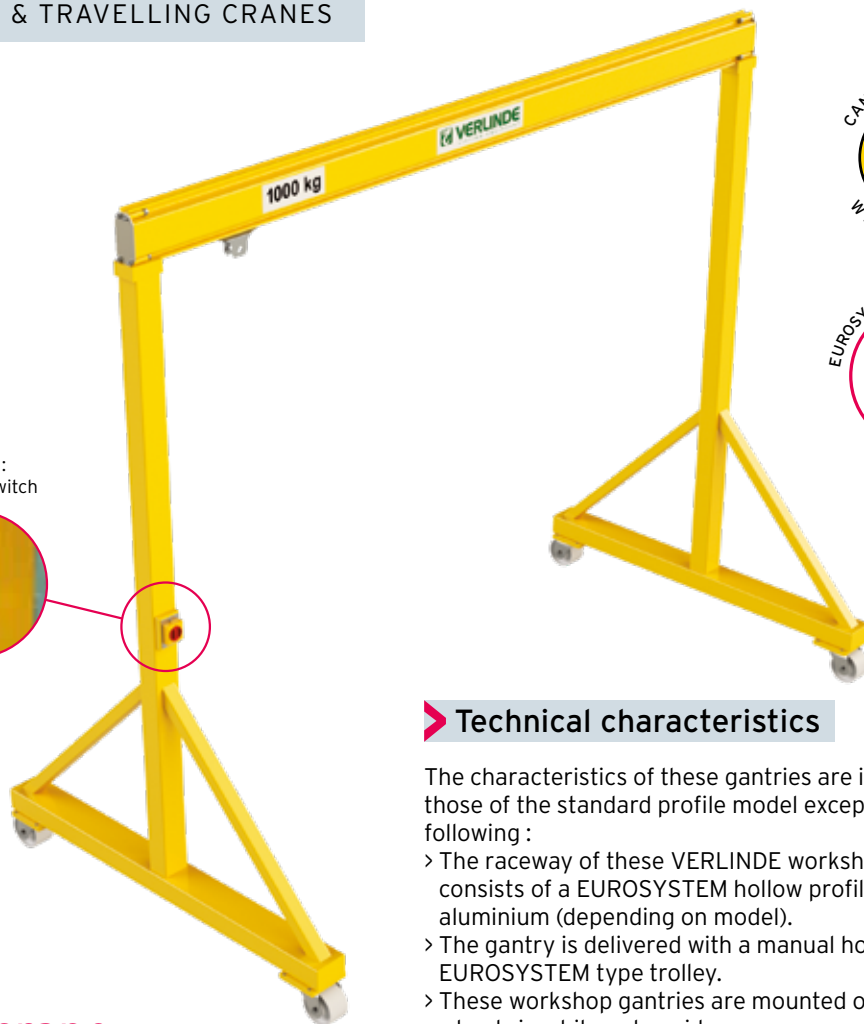

Technical characteristics

The characteristics of these gantries are identical to those of the standard profile model except for the following :

- > The raceway of these VERLINDE workshop gantries consists of a EUROSYSTEM hollow profile in steel or aluminium (depending on model).
 - > The gantry is delivered with a manual hoist-bearing EUROSYSTEM type trolley.
 - > These workshop gantries are mounted on caster wheels in white polyamide.
 - > The gantry cannot be shifted under load.
 - > On the aluminium gantry version : Legs can be folded for handling.
- Lift height and span can be adjusted by an operator alone.

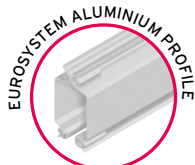

VGPA gantry crane

For loads from 500 to 2,000 kg

Load capacity

| | 250 kg | 500 kg | 1000 kg | 1600 kg | 2000 kg | 3200 kg | 5000 kg |
|---------------|--------|--------|---------|---------|---------|---------|---------|
| > VGPS gantry | | | | | | | |
| > VGPA gantry | | | | | | | |

MANUAL CRANES

Range of hand operated
top-running travelling
cranes for loads from
250 to 10,000 kg
and span of up
18 meters

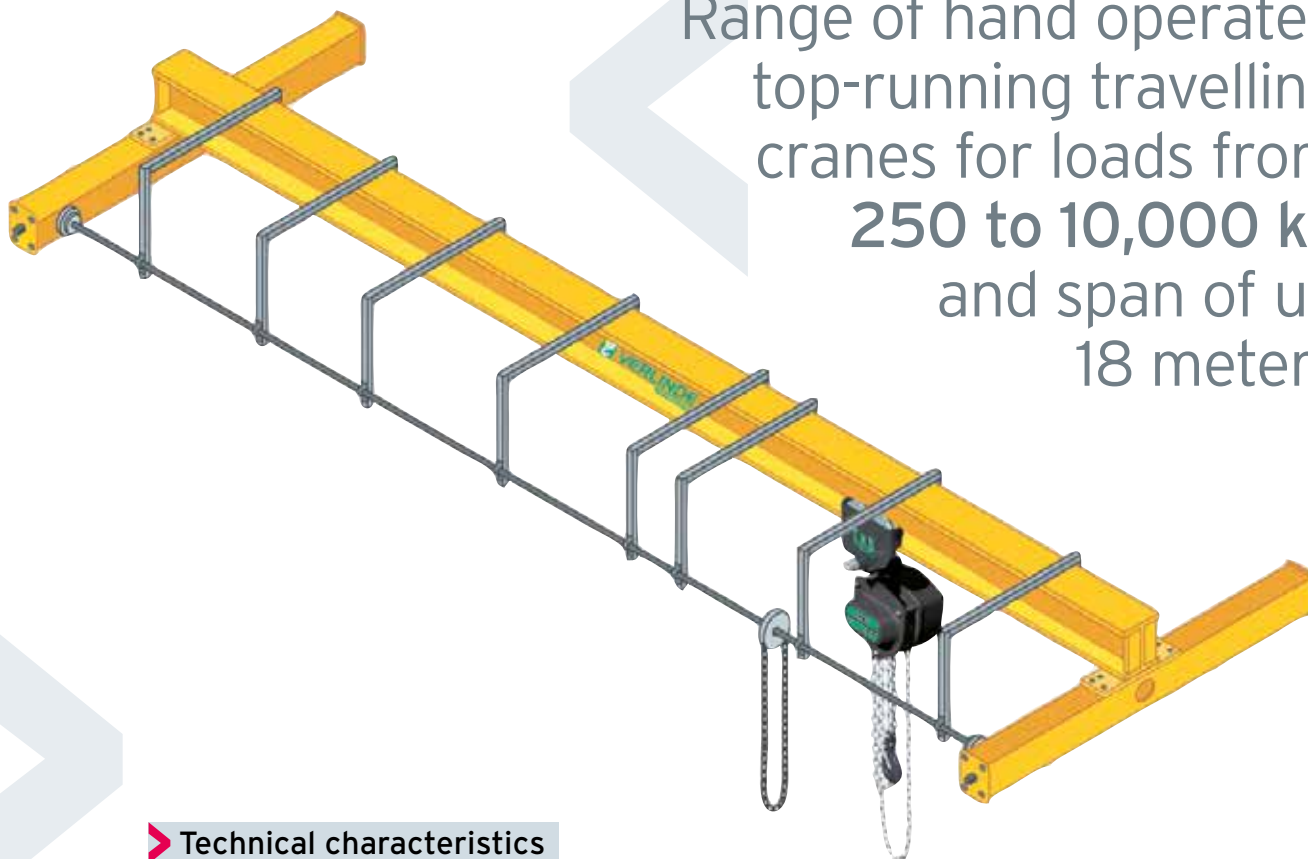

> Technical characteristics

- > Complete crane delivered ready to erect. The runway beam consists of an IPN, IPE, HEA or HEB profile, depending on the load and span, two travel movement support girders equipped with steel wheels and buffer.
- > Finish in RAL 1028 glycerophthalic lacquer.
- > Paint 24 month guarantee according to Re3 picture 7.
- > Delivered with assembly and dimension drawings.

> Load capacity

| > Span | 500 kg | 1000 kg | 2000 kg | 3000 kg | 5000 kg | 6300 kg | 8000 kg | 10000 kg |
|--------|--------|---------|---------|---------|---------|---------|---------|----------|
| > 5 m | | | | | | | | |
| > 6 m | | | | | | | | |
| > 7 m | | | | | | | | |
| > 8 m | | | | | | | | |
| > 9 m | | | | | | | | |
| > 10 m | | | | | | | | |
| > 11 m | | | | | | | | |
| > 12 m | | | | | | | | |
| > 13 m | | | | | | | | |
| > 14 m | | | | | | | | |
| > 15 m | | | | | | | | |
| > 16 m | | | | | | | | |
| > 17 m | | | | | | | | |
| > 18 m | | | | | | | | |



EUROPONT

VERLINDE

Europont is a network of french, belgium and Netherlands cranes manufacturers.

Range of EUROPONT VERLINDE travelling cranes breaks down into 7 versions and two types (conventional power supply line or cable-carrying chain) :

- > Single girder top-running overhead travelling crane with electric chain or wire rope hoist.
- > Single girder underslung overhead travelling crane in profile with electric chain or wire rope hoist.
- > Double girder top-running overhead travelling crane with electric wire rope hoist.

Double girder top running crane

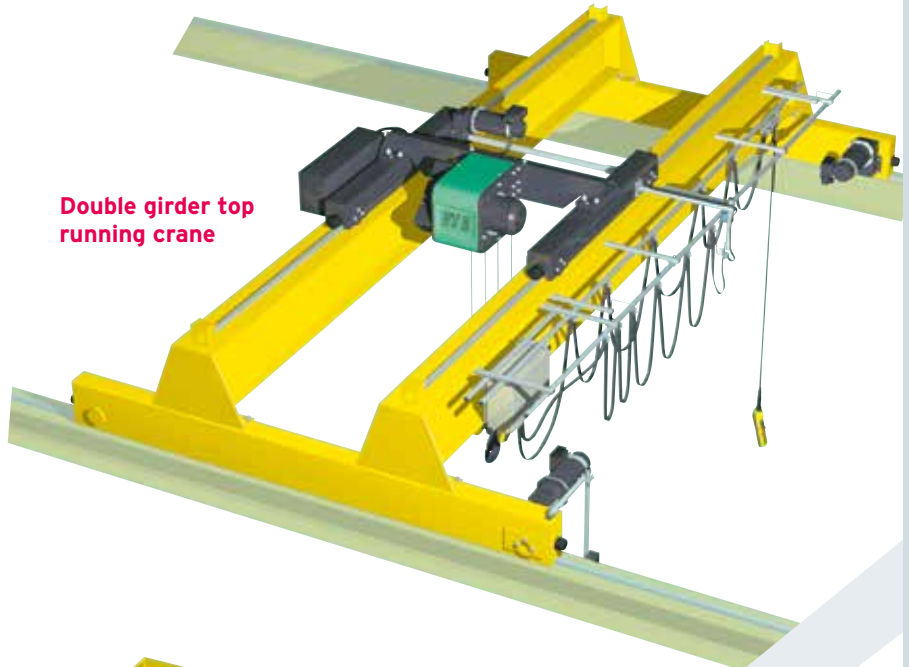

Underslung travelling crane single girder



Single girder top running crane

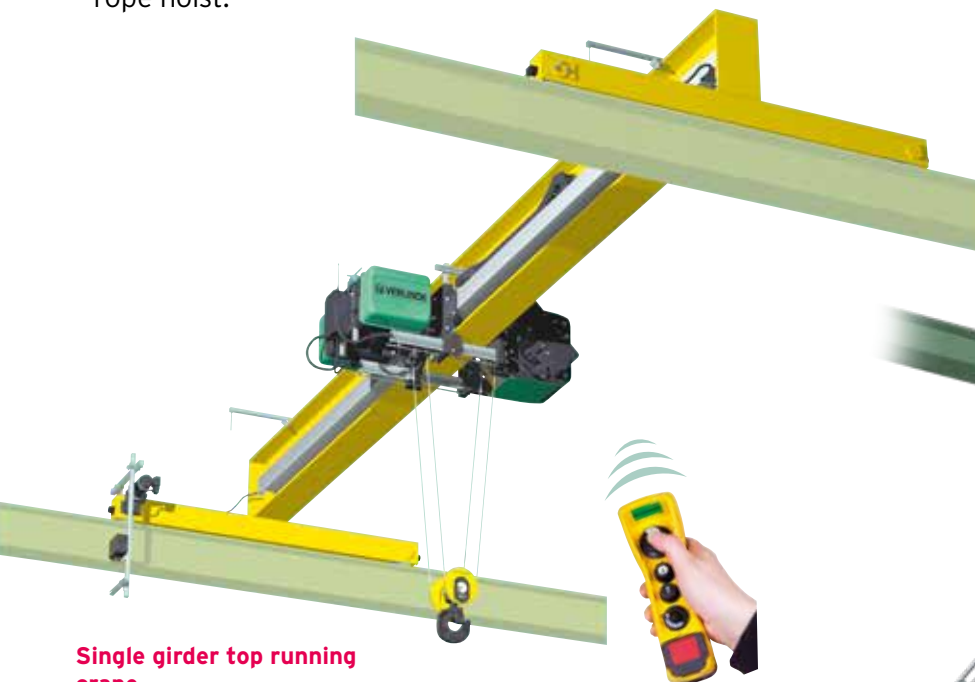

COMPOSANTS+

Travelling crane components



Top-running and underslung end carriage.



- > Wheels are also available in spark-proof version.

The range of VERLINDE components for electrically-power overhead travelling cranes offers you a complete high performance hoisting, travelling and traverse system.

General power supply line.

- > Conventional type of power line.
- > Cable holder chain power line.



Electric cabinet.

- > Sealed (IP55) steel cabinet.
- > Main isolating switch, actuatable from outside.
- > Compliant with standard NF 52070.
- > Available in explosion-proof version.



Travelling motor gear box.

- > 2 standard travel speeds : many other speed possibilities.
- > Motor-reduction set available in explosion-proof version.



Movable box.

- > Movable along the length of the crane as it travels, and independent from the hoisting device,



> Options available

- > Radio remote-control system.
- > VARIATOR : frequency inverter system for variable speed on lifting and travelling motions.
- > Electronic system for monitoring the statuses of the hoist and crane.
- > Zone lighting.
- > Luminous or audio warning system indicating that the load is in motion.
- > Digital display of load on the crane, hook or pushbutton box.

- > Load gripping system (lifting beam, clamp and clamshell)



Electronic devices

Radio remote control. Definition : radio remote control system for hoists and travelling cranes.



EUROMOTE

Radio remote control system for hoists and travelling cranes

The EUROMOTE remote control systems have been specially designed for use with the EUROBLOC and EUROCHAIN hoisting unit and the crane components of VERLINDE.

Adapted to the most severe industrial conditions, the EUROMOTE remote control systems stand out through their ease of use, great flexibility and reliability. They will enable you to improve the productivity of your operators and the safety of lifting manoeuvres and achieve productivity gains and shorter down-times.



MICROMOTE



EUROMOTE H

VARIATOR

Travel and lift speed control system for hoists and travelling cranes

VARIATOR speed control systems offer greater operating precision and flexibility for your lifting equipment.



Technical characteristics

VARIATOR speed control systems have been specially designed to be used with EUROLOC and EUROCHAIN hoisting tackles and VERLINDE crane components.

VARIATOR systems offer, with a single product, a reliable and comprehensive speed control solution (variable speed drive together with its dedicated software, brake management, main breaker, electronic surveillance system, ...) coupled with easy installation and operation.

Why should you vary the speed of your hoisting equipment ?

> Varying the speed enables the operator to move his load with greater accuracy and flexibility. VARIATOR enables the speed to be adapted to suit the load and the user's know-how of the hoisting system and production process.

Product advantages

- > Reduces the pendulum effect and can even cancel it (ESP option).
- > Increases the mechanical life span of suspended cranes and the electrical life span of lift and trolley motors.
- > Increases productivity of your hoist station.
- > Reduces energy consumption and the size of supply lines.
- > Reduces maintenance costs.
- > Optimal utilisation of work space
- > Smaller investments and faster return on investment.



VARIATOR ASR & ESR

ASR

(Adapted Speed Range)

This option enables hoist speed to be automatically adapted to the hook suspended load.

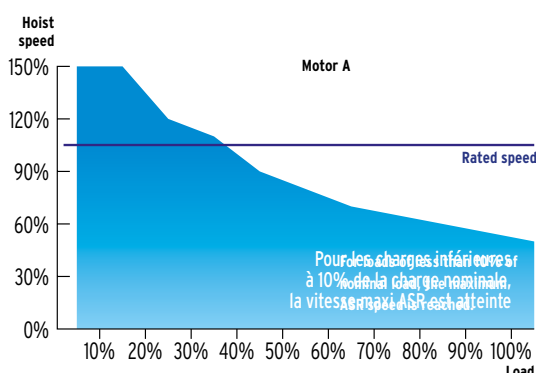

> Basic principle of operation

For most applications with type A (ASR) motors (up to 35% of nominal load), you can use the hoist at its rated speed, even above.

> Product advantages

- > Up to 50% energy savings
- > Speed depending on load obtained automatically.
- > Productivity and safety enhancement.
- > Enhancement of load travel accuracy.
- > Best return on investment.
- > Optimal use of work space and of approach data of hook.
- > Increased motor life span.
- > Use of low amperage for crane power supply to reduce the cost of investment in power-feeding systems.
- > Depending on standards and local tax systems, grants can be obtained within the framework of energy saving policies.

ESR

(Extended Speed Range)

This option allows reduction of cycle time (faster return speed for empty returns) therefore of FEM group duty.

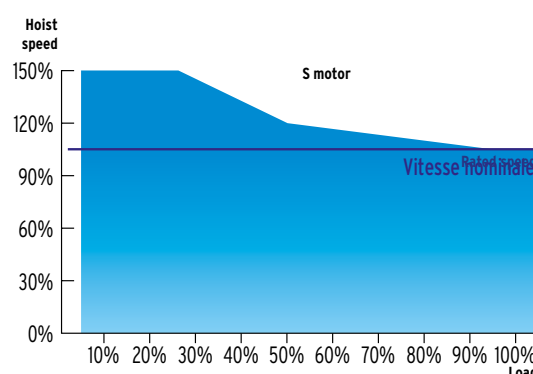

> Basic working principle

Type S (ESR) motors can be operated at full speed at up to 40% of the rated load, the max. motor speed remaining at 3000 rpm.

At 20% of the load, the rated speed is the equivalent of 150% of listed speed. With nominal load, the rated speed is the equivalent of the listed speed.

> Product advantages

- > Maximum ESR speed, 1.5 times greater than standard speed.
- > Productivity enhancement.
- > Enhancement of load travel accuracy.
- > Optimal use of work space and approach data of hook.

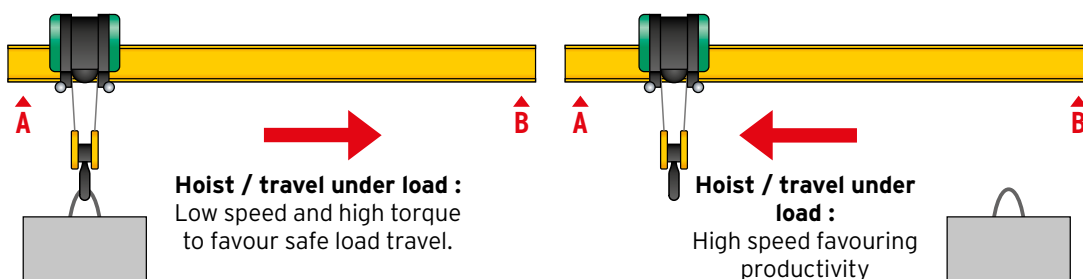

ESP

Automatic load swinging (pendulum) correction system

The effects of the swinging of loads (pendulum effect) travelling under a suspended crane were traditionally reduced if the operator had enough experience to manage load inertia movement during travel.

Basic working principle

The principle of the control of load swinging is based on the calculation of swing movement time and lifting height.

ESP calculates and automatically corrects the to-and-fro movements of the hook suspended load.

Product advantages

- › Easy parameterization of over length slinging from the control interface.
- › Increased productivity of the hoist station.
- › ESP allows the user to make use of the whole of the work space; swing correction is achieved throughout load travel whatever the height and position of the load.
- › Enhanced safety for the user personnel of the hoist station.
The operator can concentrate on the load to be shifted and not on the movements of the travelling crane.
- › Reduction of maintenance coats (reduction of the effects of mechanical stress on the structure and electrical stress on the motors)



Standards and hoisting regulations



CE directive. Since 129 December 2009, the European Machinery Directive (2006/42/EC) applies to the sale and assembly of all new machines marketed from 2010. The new decree is complementary to the former Directive, made up of 600 standards issued in 1995. That directive obliges that machine constructors ensure that their machinery complies with certain regulations, standards, national legislations and technical specifications.

F.E.M. European lifting equipment association.

S.W.P. Safe Working Period. A Safe Working Period is calculated for each electrical hoist unit according to the average operating time of the hoisting equipment, load capacity and class of application.

After this period, a general service carried out by the constructor is necessary.

Class of operation. According to FEM classification, two fundamental criteria must be taken into account : the type of duty and the class of duty (according to average daily operation time average load).

ISO standard. Classes of operation can also be defined according to ISO grouping (1Am =M4, 2m =M5, 3m =M6, etc.).

Type of duty.

>**Light service.** Equipment rarely subject to maximum load and frequently to very little load.

>**Medium service.** Equipment rarely subject to maximum load and frequently to very little load.

>**Heavy service.** Equipment frequently subject to maximum load and frequently to medium load.

>**Very heavy service.** Equipment frequently subject to maximum or near maximum load.

| Average daily operating time in hours | | | | ≤ 0,5 | | ≤ 1 | | ≤ 2 | | ≤ 4 | | ≤ 8 | | ≤ 16 | |
|---------------------------------------|---|----|------------|-------|----|------|----|------|----|------|----|------|----|------|----|
| Class of duty | | | | V0,25 | T2 | V0,5 | T3 | V1 | T4 | V2 | T5 | V3 | T6 | V4 | T7 |
| Class of duty | 1 | L1 | Light | | | | | 1Bm | M3 | 1Am | M4 | 2m | M5 | V4 | M6 |
| | 2 | L2 | Medium | | | 1Bm | M3 | 1Am | M4 | 2m | M5 | 3m | M6 | | |
| | 3 | L3 | Heavy | 1Bm | M3 | 1Am | M4 | 2m | M5 | 3m | M6 | | | | |
| | 4 | L4 | Very Heavy | 1Am | M4 | 2m | M5 | 3m | M6 | | | | | | |
| Group | | | | | | | | 1Bm | M3 | 1Am | M4 | 2m | M5 | 3m | M6 |
| Duty factor* | | | | | | | | 25 % | | 30 % | | 40 % | | 50 % | |
| Number of starts per hour | | | | | | | | 150 | | 180 | | 240 | | 300 | |

■ F.E.M. standard specification 9511 ■ ISO standard specification.

* Duty factor in % = $\frac{\text{Hoisting time} + \text{Lowering time}}{\text{Hoisting time} + \text{idle time} + \text{Lowering time} + \text{idle time}} \times 100$

Glossary

C

CHV®. Electrically powered travelling trolley for loads of 125 to 3,000 kg.
CHD®. Manually-operated travelling trolley for loads of 500 to 20,000 kg.

Classes of operation. See complete definition above.

Command height. Distance between the push-button box and the hoist.

Coupled. The hoist is coupled to a travelling trolley with a coupling strap, this option is used in order to obtain shorter headroom.

D

Degree of protection (IP). IP XX, The first parameter defines the degree to which it is sealed against dust, the second the degree of water-tightness. IP 54 is generally for inside use and IP 55 for outside use.

Direct control. Voltage control of the hoist via the power supply voltage in the pushbutton box.

Double-girder. Travelling trolley used to move the hoist along 2 tracks.

E

Emergency stop. Mushroom-head switch located on the push-button box that enables the machine to stop immediately by means of a circuit breaker in the control panel.

EQUIBLOC®. Load spreading system for loads of 0,7 to 55 kg.

EUROBLOC®. Electric wire rope hoist for loads of 800 to 250,000 kg.

EUROCHAIN®. Electric chain hoist for loads of 60 to 10,000 kg.

EUROLIFT®. Electric belt hoist for loads of 500 to 5,000 kg.

EUROMOTE®. Radio and infra-red remote control systems.

EUROPONT® by VERLINDE. EUROPONT electric travelling cranes, constructed in compliance with EU standards comprising VERLINDE components.

EUROSTYLE®. Manually-operated or motor-driven slewing cranes for loads of 125 to 10,000 kg.

EUROSYSTEM®. Overhead mechanical handling system for loads of 50 to 2,000 kg.

F

FEM. European lifting equipment association (Fédération Européenne de la Manutention).

FEM/ISO Classification. See complete definition above.

H

Headroom HPR : reduced headroom, HPN : standard headroom. Headroom of the hoist Hook suspended. The hoist is hooked to the travelling trolley by the upper hook ; this option enables the hoist to be used in multi-station configurations.

Height of lift (HOL). Total distance between the ground and the hooking support.

L

Limit switches. 2 types : hoisting and travelling. Safety feature that stops the machine in the event of the hook travel or travel distance continuing beyond the limits.

Load capacity (kg). Nominal maximum load for hoisting equipment.

Load limiter. Protects the hoist against overloading (European Machinery Directive 91/368/EEC. Compulsory for hoists with a load capacity equal to or greater than 1,000 kg).

Low voltage control. 48 V hoist control (in the push-button box).

M

ME®. Geared manually-operated winches for loads of 150 to 2,000 kg.

MONITOR®. Electronic control system for a hoisting unit.

Monorail. A single-rail system for load travel.

Motor gear. Hoisting or travel motor and reduction assembly.

MV. Worm-gear manually-operated winches for loads of 250 to 3,000 kg.

N

Number of falls. Number of sections of chain, rope wire or belt used to hoist the load.

O

ON/OFF. On/Off switch.

P

PAP®. Girder clamps for loads of 1,000 to 5,000 kg.

Percentage duty factor. See complete definition above.

PEV®. Digital electronic force gauge.

PLV®. Manually-operated lever hoist for loads of 250 to 3,000 kg.

Pendant push-button box. Control interface between the operator and the electric hoisting unit.

R

Reduction gear. 2 types : hoisting and travelling. Several reduction gear techniques are used for hoisting : standard gearing, 2 or 3 helical gears, planetary gearbox etc.

S

Safety coefficient. This parameter multiplied by the load capacity is used to define the rupture limit of a component. It is generally given for the hoisting chain or rope.

Support girders. 2 types : mounted or overhead. Translation movement devices used for horizontal displacement of travelling crane girders.

SWL (Safe working load). See load capacity.

T

TEC®. Work-site electric winches for loads of 600 to 7,500 kg.

Thermistor. Thermic motor protection device.

TIRLIFT®. Electric winches for loads of 125 to 990 kg.

TLV®. Manually-operated lever winches for loads of 800 to 3,200 kg.

True vertical lifting. Enables the load to be raised and lowered without the hook needing to be moved laterally.

U

Utilisation group. Refer to full definition above.

V

VARIATOR®. Hoisting or travelling speed inverter system.

VHR®. Heavy duty usage-type manually-operated hoist for loads of 250 to 10,000 kg.

Request for technical brochures

Fax this page to :

+33 2 37 38 95 99

We would like to receive your technical brochure(s) for the following product(s)



| | | |
|----------------------------------|--|--------------------------|
| Electric hoists and winches | EUROCHAIN VX | <input type="checkbox"/> |
| | STAGEMAKER | <input type="checkbox"/> |
| | EUROBLOC VT | <input type="checkbox"/> |
| | EUROBLOC VT9-10-11-12 | <input type="checkbox"/> |
| | EUROLIFT BH | <input type="checkbox"/> |
| | WINCHES | <input type="checkbox"/> |
| Manual hoists and winches | VHR | <input type="checkbox"/> |
| | ZHV ZHV INOX | <input type="checkbox"/> |
| | PLV | <input type="checkbox"/> |
| | WINCHES | <input type="checkbox"/> |
| Trolleys and accessories | CHD - CHDD | <input type="checkbox"/> |
| | CHVX | <input type="checkbox"/> |
| | PRD | <input type="checkbox"/> |
| | PRV | <input type="checkbox"/> |
| | PAP | <input type="checkbox"/> |
| | EQUIBLOC | <input type="checkbox"/> |
| | EQUIBLOC AIR | <input type="checkbox"/> |
| | LIMITER | <input type="checkbox"/> |
| | PEV | <input type="checkbox"/> |
| | PAL | <input type="checkbox"/> |
| Jib cranes and travelling cranes | EUROSYSTEM | <input type="checkbox"/> |
| | EUROSTYLE | <input type="checkbox"/> |
| | EUROSTYLE H₂O | <input type="checkbox"/> |
| | GANTRIES | <input type="checkbox"/> |
| | MANUAL CRANES | <input type="checkbox"/> |
| | EUROPONT | <input type="checkbox"/> |
| | COMPOSANTS+ Travelling crane components | <input type="checkbox"/> |
| Electronic devices | MICROMOTE | <input type="checkbox"/> |
| | EUROMOTE | <input type="checkbox"/> |
| | VARIATOR | <input type="checkbox"/> |
| | ESR-ASR-ESP | <input type="checkbox"/> |
| Verlindé other department | VERLINDE TECHNOLOGIES | <input type="checkbox"/> |
| Others documentations | FOOD PROCESS | <input type="checkbox"/> |
| | OFFSHORE | <input type="checkbox"/> |
| | CLEANROOM | <input type="checkbox"/> |

Company :

Name (or Name / First name for persons) :

Address :

Zip code :

City :

Country :

Telephone :

Fax :

E-mail :



VERLINDE is:

- The leading French distributor and exporter of lifting and handling equipment.
- A comprehensive range of 30 groups of lifting equipment from 60 to 250,000 kg.
- ISO 9001 Quality control certified and ISO 14001 Environmental Management Systems.

In France:

A sales network and after sales service points, EUROPONT travelling crane construction plants and a distributor network.

Abroad:

A customer service in more than 92 countries.

References

Metallurgy, Mechanics, Nuclear
ArcelorMittal, Unimetal, Stein, NFM,
Framatome, Alstom

Chemicals, Petrochemicals industry
Sanofi Aventis, Total,
Du Pont De Nemours

Aeronautical industry
Aérospatiale, Airbus,
Snecma, Eurocopter,
Air France, Aéroport de Paris,
Dassault Aviation



Agri-food industry
Nestlé, Danone, Bel, Palamatic,
Tetrapak, Lactalis

Automobile industry
Renault, Peugeot, Citroën, Scania,
Ford, RVI, Volkswagen, Michelin,
Massey Fergusson, Manitou,
Toyota Industrial Equipment

Other sectors
EDF, SNCF, RATP, Spie, Degremont,
Eiffage, Polysius, Baudin Chateaufort



NEXT LEVEL
PARTNERSHIP

2, boulevard de l'Industrie | B.P. 20059 | 28509 Vernouillet cedex | France
Phone : (33) 02 37 38 95 95 | Fax : (33) 02 37 38 95 99 | Internet : www.verlinda.com

